

Sandblasted type.

Body and ball
Hand lever / butterfly handle
Ball seal
Stem seal
Medium and ambient temperature
Operating pressure
Applications

Nickel-plated brass
Plastic
PTFE
FKM
-10 °C to +90 °C
max. 10 bar
Compressed air, water, oils, non-toxic gases

Ball valves with butterfly handle								
Art. No.	Ident No.	Thread	a/f mm	DN	A mm	L mm	T mm	T1 mm
373.01	103327	G 1/4 female	21	8	-	41.5	9.0	10.5
373.02	103328	G 3/8 female	21	8	-	41.5	12.0	10.0
373.03	103329	G 1/2 female	24	10	-	47.0	12.5	10.5
373.11	103330	G 1/4 female /male	21	8	-	41.5	9.0	10.5
373.22	103331	G 3/8 female /male	21	8	-	40.5	10.0	10.0
373.33	103332	G 1/2 female /male	25	10	-	46.0	12.0	10.6

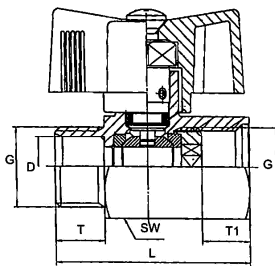

373.01

Ball valves with hand lever								
Art. No.	Ident No.	Thread	a/f mm	DN	A mm	L mm	T mm	T1 mm
374.01	103333	G 1/4 female	21	8	68.5	41.5	9.0	10.5
374.02	103334	G 3/8 female	21	8	68.5	41.5	12.0	10.0
374.03	103335	G 1/2 female	25	10	68.5	47.0	12.5	10.5
374.11	103336	G 1/4 female /male	20	8	68.5	41.5	9.0	10.5
374.22	103337	G 3/8 female /male	21	8	68.5	40.5	10.0	10.0
374.33	103338	G 1/2 female /male	25	10	68.5	46.0	12.0	10.6

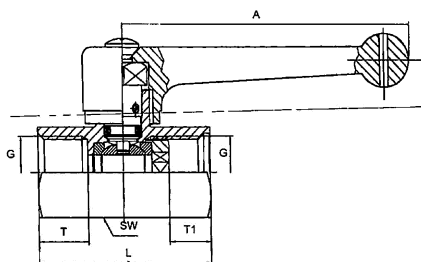

374.01

Subject technical changes.