

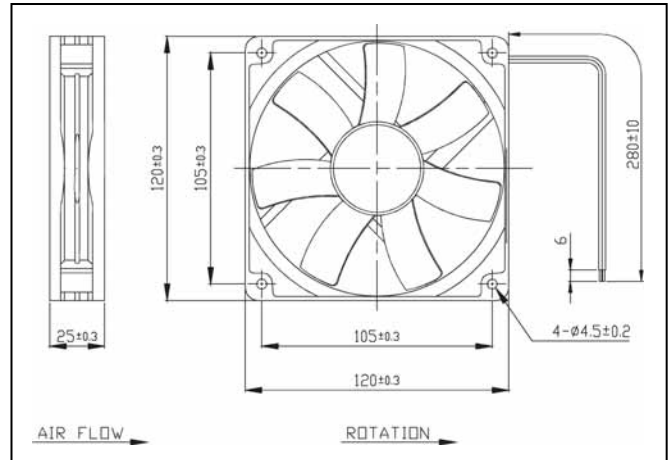

DRAWING



FEATURES

- Glass fibre reinforced plastic (PBT) fan casing and impeller.
- Brushless dc motor. I.C. protected against running overload.
- Electrical connection via 2 leads UL1007 AWG24, 280mm long.
- Rated temperature range:
Ball bearing from -20°C to +70°C
Sleeve bearing from -10°C to +60°C
Hypro bearing from -10°C to +60°C
- Service life L10:
Ball bearing 70,000 hours at 40°C
40,000 hours at t max
Sleeve bearing 50,000 hours at 40°C
35,000 hours at t max
Hypro bearing 70,000 hours at 40°C
40,000 hours at t max
- Weight 170g.

AIR FLOW CURVES

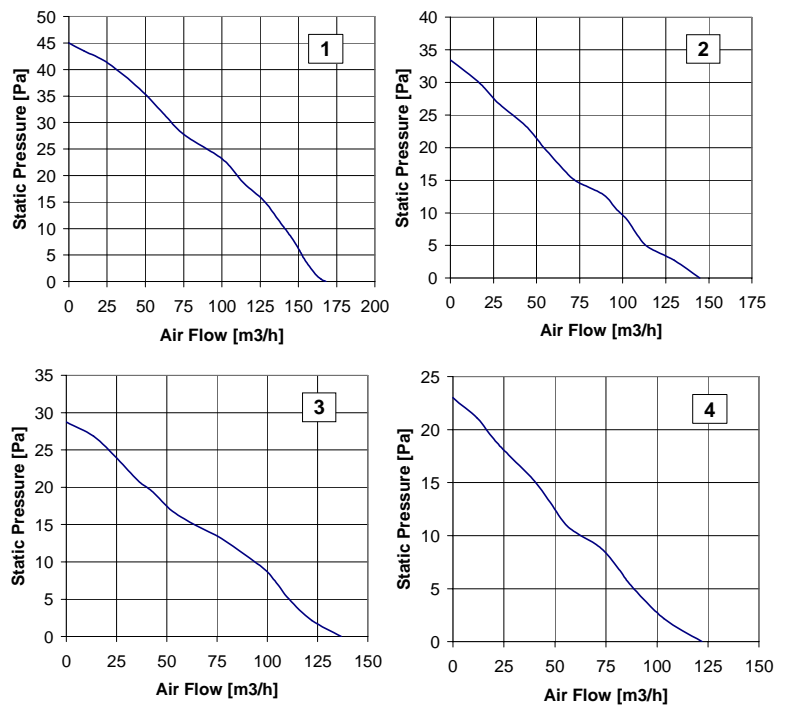

Please refer to our terms of sales including our warranty and limited liabilities clauses.

Model	Diagram	Bearing #			Rated Voltage [V]	Input Power [W]	Speed [rpm]	Air Flow [m3/h]	Static Pressure [Pa]	Noise [dB(A)]	Approvals		
		S	H	B							UL	CUL	TUV
D12A04SW#Z00	1	★	★	★	12	6.0	2500	168	45	43.3	S,H,B		
D12A04HW#Z00	2	★	★	★	12	5.3	2200	145	33	39.1	S,H,B		
D12A04MW#Z00	3	★	★	★	12	4.1	2050	137	29	38.0	S,H,B		
D12A04LW#Z00	4	★	★	★	12	2.9	1800	122	23	34.4	S,H,B		
D12A05SW#Z00	1	★	★	★	24	6.0	2500	168	45	43.3	S,H,B		
D12A05HW#Z00	2	★	★	★	24	4.6	2200	145	33	39.1	S,H,B		
D12A05MW#Z00	3	★	★	★	24	4.1	2050	137	29	38.0	S,H,B		
D12A05LW#Z00	4	★	★	★	24	3.4	1800	122	23	34.4	S,H,B		

"#": S= Sleeve, H= Hypro, B= Ball



Fandis S.p.A. Via per Castelletto, 69
28040 Borgoticino (No) Italy
Tel. +39 0321 96.32.32 Fax +39 0321 96.32.96
info@fandis.it • www.fandis.it

COMPANY WITH QUALITY SYSTEM CERTIFIED BY DNV = ISO 9001/2000 =

All specifications, data and drawings are subject to change without notice and are approximate.

CSV-J10/3