

# MDX(L) series

Slide table cylinder

CHELIC PNEUMATIC

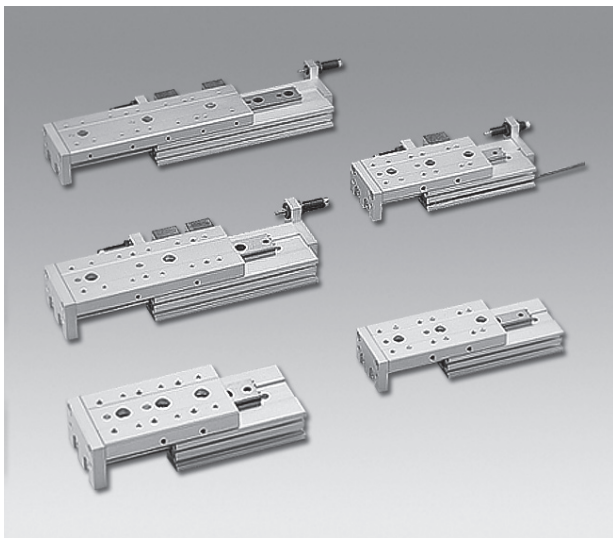

MDX(L) series provide **CAD** external dimension.



MDX

MDXL

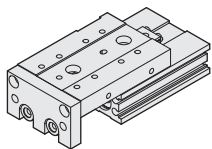

**MDX series** ----- Slide Table Cylinder -----  $\varnothing 6 \sim \varnothing 25$  ----- P.13-3.1

Slide type dual-rod cylinder, double force, rods made of medium carbon steel plated hard chromium, grinding the surface ; and hard anodized treatment, cylinder body with 0.3mm hard surface, use imported slide rail, O-ring and packing.

**MSR(L)**  
Slide Table  
Cylinder

**FMR(L)**  
Slide Table  
Cylinder

**MDX**  
Slide Table  
Cylinder

**MDXL**  
Slide Table  
Cylinder

**MQX**  
Compact  
Slide  
Cylinder

New

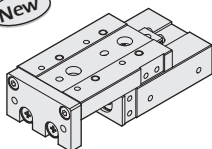

**MDXL series** ----- Slide Table Cylinder -----  $\varnothing 6 \sim \varnothing 25$  ----- P.13-3.12

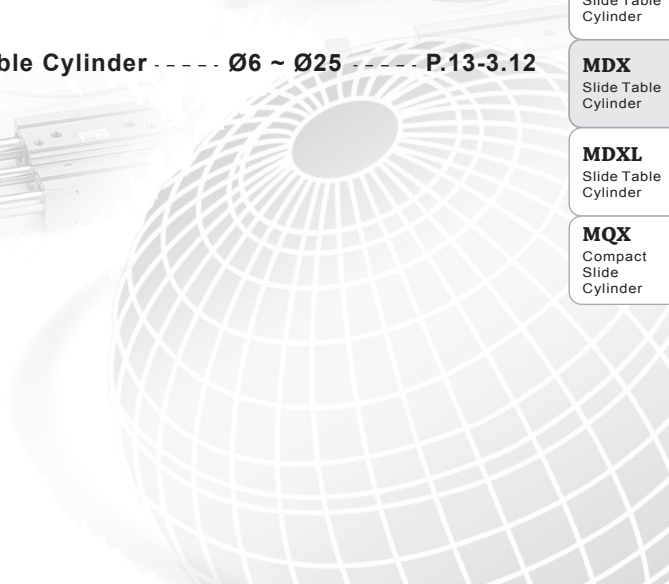

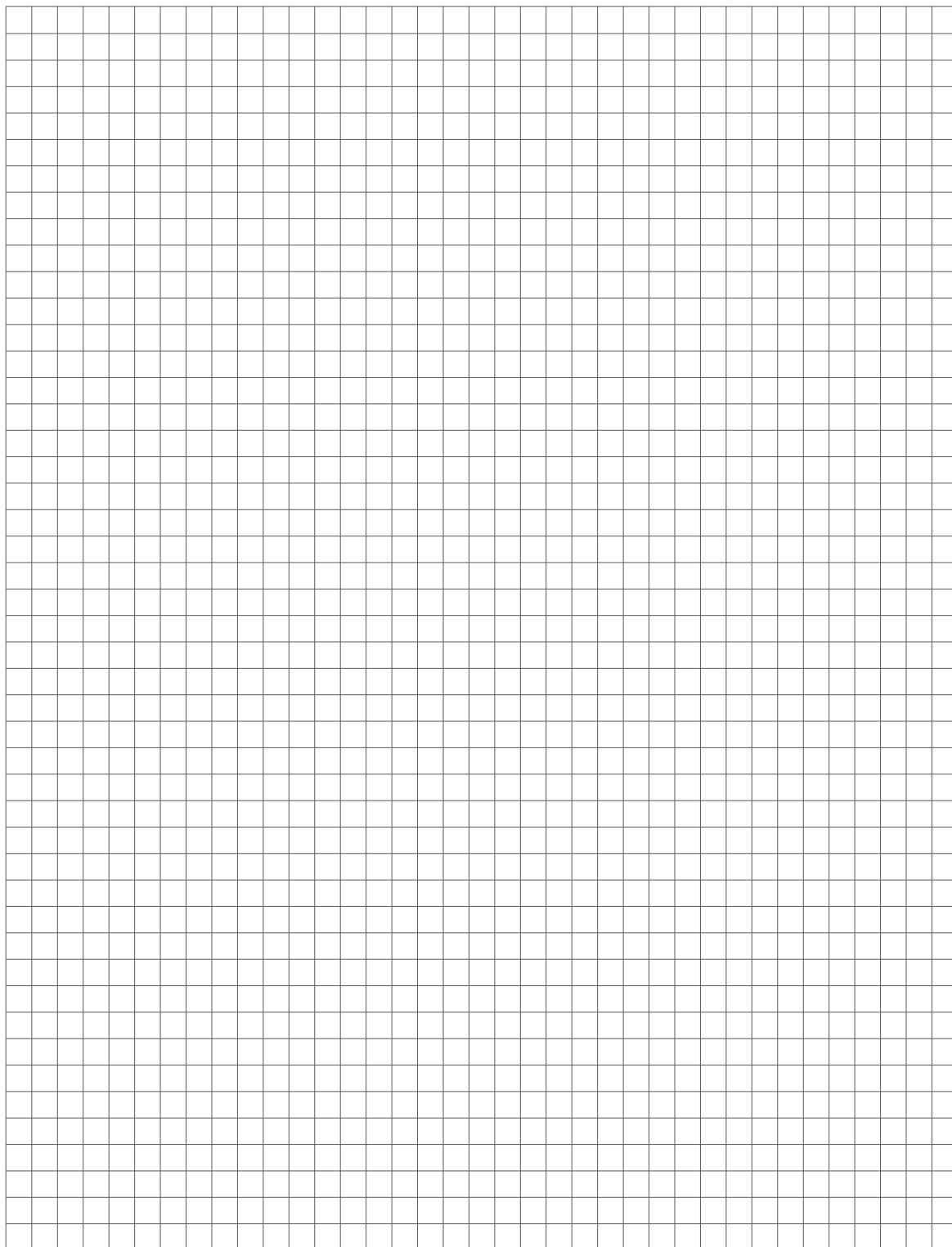

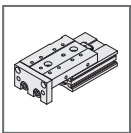

# MDX(L) series - SLIDE TABLE CYLINDER

Specification list and Ordering expression

CHELIC PNEUMATIC

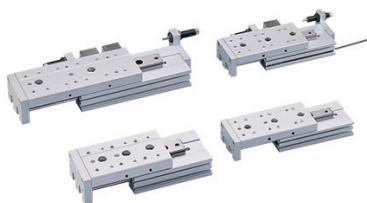

## Internal structure

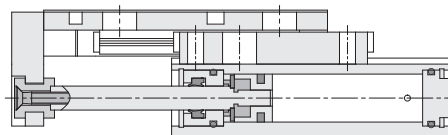

## Theoretical force

Bore size mm	Piston rod mm	Action	Piston area	Air pressure (kgf/cm <sup>2</sup> )						
				1	2	3	4	5	6	7
6	3	Push	0.5	—	1.0	1.5	2.0	2.5	3.0	3.5
		Pull	0.4	—	0.8	1.2	1.6	2.0	2.4	2.8
8	5	Push	1.0	1.0	2.0	3.0	4.0	5.0	6.0	7.0
		Pull	0.7	0.7	1.4	2.1	2.8	3.5	4.2	4.9
12	6	Push	2.2	2.2	4.4	6.6	8.8	11	13.2	15.4
		Pull	1.7	1.7	3.4	5.1	6.8	8.5	10.2	11.9
16	8	Push	4.0	4.0	8.0	12	16	20	24	28
		Pull	3.0	3.0	6.0	9.0	12	15	18	21
20	10	Push	6.2	6.2	12.4	18.6	24.8	31	37.2	43.4
		Pull	4.7	4.7	9.4	14.1	18.8	23.5	28.2	32.9
25	12	Push	9.8	9.8	19.6	29.4	39.2	49	58.5	68.6
		Pull	7.5	7.5	15	22.5	30	37.5	45	52.5

Note : The above data are for reference only. When come to actual practice, frictional force and the mechanical efficiency have to be taken into considerations. (About 70%~80%)

## Specification

New

Unit : mm

Item	Bore size	Ø6	Ø8	Ø12	Ø16	Ø20	Ø25
Operation	Double acting						
Fluid	Air						
Pressure range	kgf/cm <sup>2</sup> (Kpa)	1 ~ 8.5 (100 ~ 850)					
Max. service pressure	kgf/cm <sup>2</sup> (Kpa)	9.5 (950)					
Range of service temperature	°C	0 ~ 60					
Range of speed	mm/sec	100 ~ 500					
Connection port		M3×0.5p	M5×0.8p		RC 1/8		
Sensing device		With magnet					

## Bore size and Stroke

Bore size (mm)	Standard stroke
6	10、20、30、40、50
8	10、20、30、40、50、75
12	10、20、30、40、50、75、100
16	10、20、30、40、50、75、100、125
20	10、20、30、40、50、75、100、125、150
25	10、20、30、40、50、75、100、125、150

## How to order

**MDX** (Model) × **12** (Bore size) × **50** (Stroke) - **SD 2** (Sensor switch) - **B.M 2** (Shock absorber)

**MDX** : Slide table cylinder

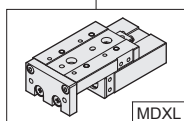

**MDXL** : Slide table cylinder

### How to select shock absorber

Bore size	Shock absorber	Max. absorb function
6	—	—
8	SAC-0806	0.2 kgf.m
12	SAC-0806	0.2 kgf.m
16	SAC-1008	0.4 kgf.m
20	SAC-1412	1.5 kgf.m
25	SAC-1412	1.5 kgf.m

Expression: Shock absorber is mounted on the side of body so as to absorb the impact force.  
(Please indicate AM code number; M is shock absorber mounting sets)

M1 : Front shock absorber mounting sets  
M2 : Front-back shock absorber mounting sets  
M3 : Back shock absorber mounting sets

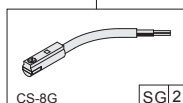

None: without sensor  
SG: Sensor code (CS-8G)

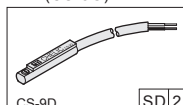

None: without sensor  
SD: Sensor code (CS-9D)  
SB: Sensor code (CS-9B)  
2: Number of sensor  
1 = 1PCS  
2 = 2PCS

M Shock absorber mounting set (middle shock is 2 pcs when stroke is over 75)

**MSR(L)**  
Slide Table Cylinder

**FRM(L)**  
Slide Table Cylinder

**MDX**  
Slide Table Cylinder

**MDXL**  
Slide Table Cylinder

**MQX**  
Compact Slide Cylinder

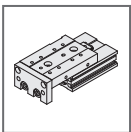

# MDX(L) series - SLIDE TABLE CYLINDER

## Component and Material list

CHELIC PNEUMATIC

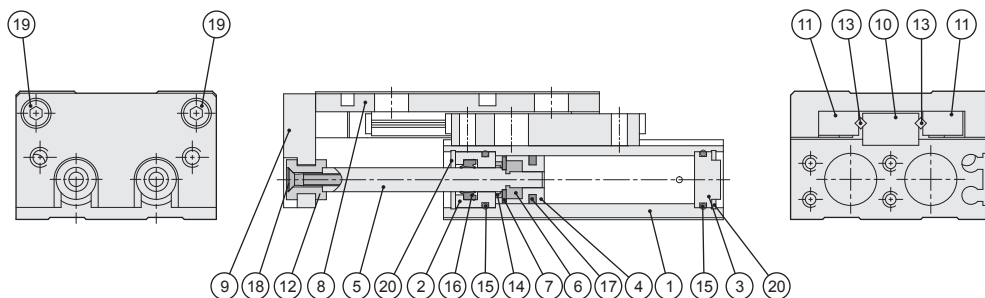

### Component and Material list

No.	Item	Material	No.	Item	Material
01	Body	Aluminum alloy	11	Slide rail	Bearing steel
02	Front cover	Aluminum alloy	12	Rod fixed	Iron
03	End cover	Aluminum alloy	13	Roller	Bearing steel
04	Piston	Copper alloy	14	Rubber lining	Rubber
05	Main rod	Medium carbon steel	15	O-ring	NBR
06	Magnet	Rubber	16	Rod packing	NBR
07	Magnet cover	Copper alloy	17	Piston packing	NBR
08	Slide base	Aluminum alloy	18	Screw	Alloy steel
09	Front plate	Aluminum alloy	19	Screw	Alloy steel
10	Rail	Bearing steel	20	C snap ring	Spring steel

### Packing and O-Ring

Unit : mm

Bore size	Item	Piston packing	Rod packing	Front cover O-ring	End cover O-ring
	Number	2	2	2	2
Ø6		MYA-3 (4 pcs)	MYA-3	Ø5 × Ø1	Ø5 × Ø1
Ø8		DYP-8 (4 pcs)	DYR-5	Ø8 × Ø1	Ø8 × Ø1
Ø12		COP-12	PDU-6	Ø10.5 × Ø1.5	Ø10.5 × Ø1.5
Ø16		COP-16	PDU-8	Ø13.2 × Ø1.5	Ø13.2 × Ø1.5
Ø20		COP-20	PDU-10	Ø19.5 × Ø1.5	Ø19.5 × Ø1.5
Ø25		COP-25	PDU-12	Ø24.5 × Ø2	Ø24.5 × Ø2

Note : Use MITSUBISHI, SAKAGAMI or the same degree for piston packing and rod packing.

### Weight

Bore size (mm)	Weight (kg)								
	Stroke (mm)								
	10	20	30	40	50	75	100	125	150
Ø6	0.1	0.1	0.1	0.1	0.2	—	—	—	—
Ø8	0.1	0.1	0.2	0.2	0.3	0.4	—	—	—
Ø12	0.3	0.3	0.3	0.4	0.5	0.7	0.9	—	—
Ø16	0.6	0.6	0.6	0.7	0.8	1.1	1.4	1.8	—
Ø20	1	1	1	1.1	1.3	1.7	2.2	2.7	3.2
Ø25	1.7	1.7	1.7	1.9	2.1	2.7	3.4	4.2	4.8

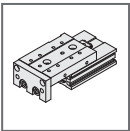

# MDX(L) series - SLIDE TABLE CYLINDER

Design and Installation (Reference)

CHELIC PNEUMATIC

## ○ The calculation method of the allowed motionless load.

- Vertical moment of force

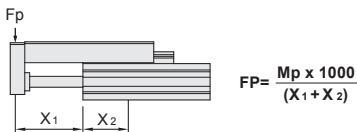

- Leaning sway moment of force

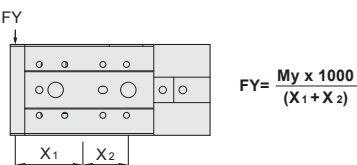

- Roll moment force

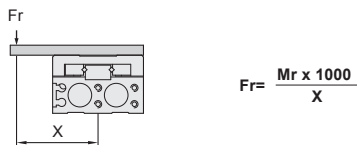

## ○ Motionless allowable moment of force

N · m

Bore size	Stroke (mm)								
	10	20	30	40	50	75	100	125	150
Ø6	0.7	1.0	1.2	1.2	1.2	—	—	—	—
Ø8	2.0	2.0	2.8	3.6	4.2	4.2	—	—	—
Ø12	4.2	4.2	4.2	5.8	7.0	10.0	10	—	—
Ø16	11.3	11.3	11.3	11.3	15.9	25.0	34.1	34.1	—
Ø20	19.4	19.4	19.4	19.4	27.2	35	50.5	50.5	50.5
Ø25	30.6	30.6	30.6	30.6	42.8	55.1	67.3	67.3	67.3

### Note :

- Please do not exceed load limit. It will effect on the precision of the slide rail if it exceeds the limit.
- Avoid hitting with great force.
- Inertial load must be with in 1/10 or the allowable motionless load.

### Description :

- X1 is the distance from body to point of load.
- X2 is the center distance from body to slide.
- X is the distance from (Fr) point of load to slide rail holder.

## ○ Maximum allowable load weight

Unit : Kg

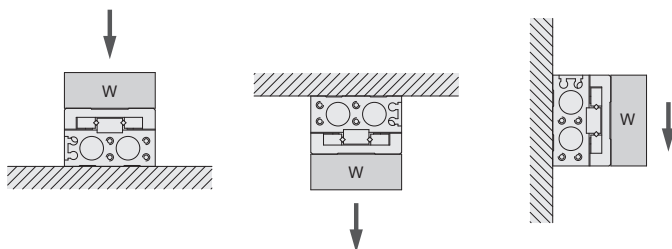

Bore size	Max. allowable load weight
Ø 6	0.6
Ø 8	1
Ø 12	2
Ø 16	4
Ø 20	6
Ø 25	9

## ○ Mounting type

- Top mounting type

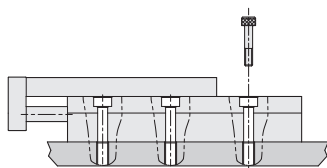

- Bass mounting

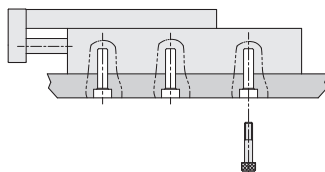

- End vertical mounting

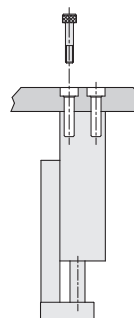

**MSR(L)**  
Slide Table  
Cylinder

**FMR(L)**  
Slide Table  
Cylinder

**MDX**  
Slide Table  
Cylinder

**MDXL**  
Slide Table  
Cylinder

**MQX**  
Compact  
Slide  
Cylinder

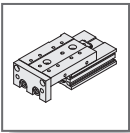

# MDX(L) series - SLIDE TABLE CYLINDER

Design and Installation (Reference)

CHELIC PNEUMATIC

## Slide base deflection (Reference)

- Slide base displacement due to pitch moment load

Slide base displacement when loads are applied to the section marked with the arrow at the full stroke.



MDX/MDXL Ø6

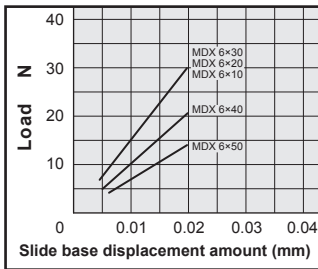

MDX/MDXL Ø8

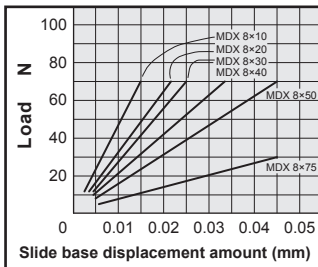

MDX/MDXL Ø12

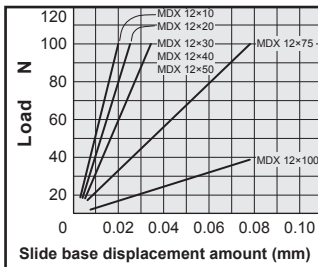

- Slide base displacement due to yaw moment load

Slide base displacement when loads are applied to the section marked with the arrow at the full stroke.

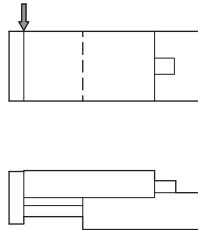

MDX/MDXL Ø6

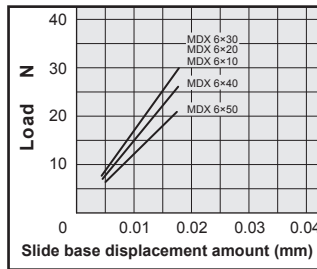

MDX/MDXL Ø8

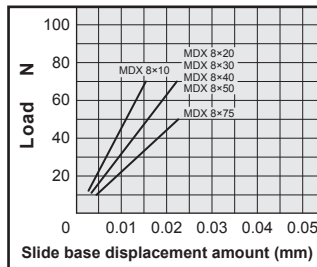

MDX/MDXL Ø12

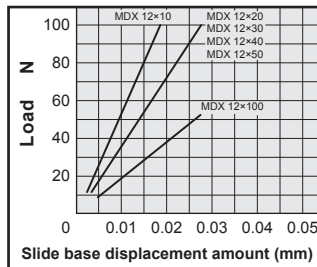

- Slide base displacement due to roll moment load.

Slide base displacement of section A when loads are applied to the section f with the slide table retracted.

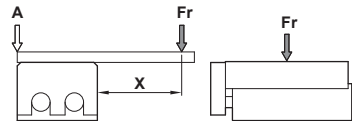

MDX/MDXL Ø6

X = 24 mm

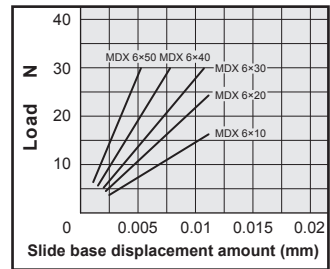

MDX/MDXL Ø8

X = 50 mm

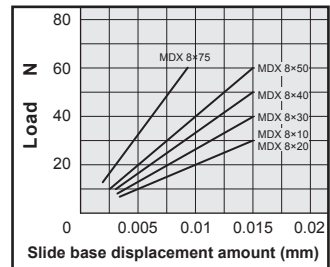

MDX/MDXL Ø12

X = 65 mm

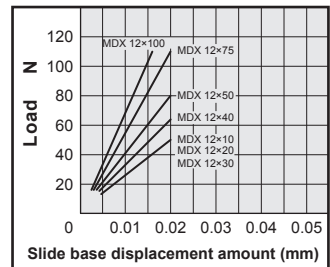

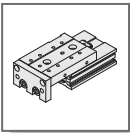

# MDX(L) series - SLIDE TABLE CYLINDER

Design and Installation (Reference)

CHELIC PNEUMATIC

## Slide base deflection (Reference)

- Slide base displacement due to pitch moment load

Slide base displacement when loads are applied to the section marked with the arrow at the full stroke.

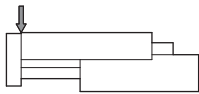

MDX/MDXL Ø16

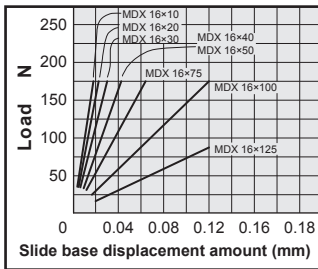

MDX/MDXL Ø20

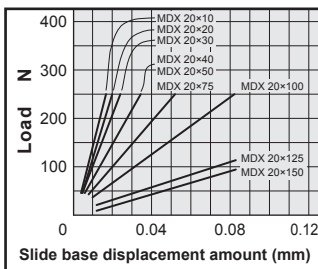

MDX/MDXL Ø25

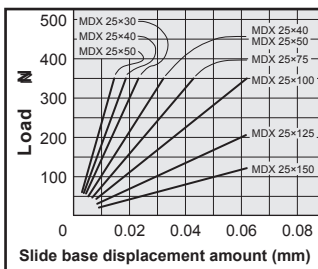

- Slide base displacement due to yaw moment load

Slide base displacement when loads are applied to the section marked with the arrow at the full stroke.

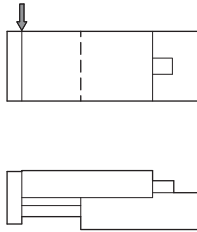

MDX/MDXL Ø16

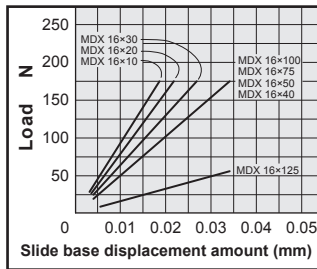

MDX/MDXL Ø20

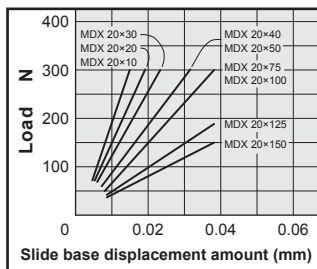

MDX/MDXL Ø25

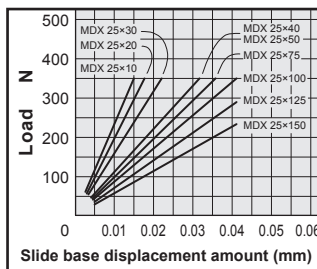

- Slide base displacement due to roll moment load.

Slide base displacement of section A when loads are applied to the section f with the slide table retracted.

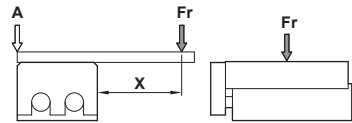

MDX/MDXL Ø16

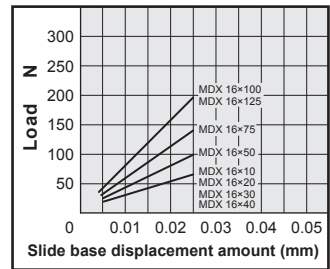

MDX/MDXL Ø20

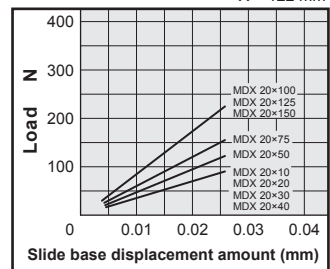

MDX/MDXL Ø25

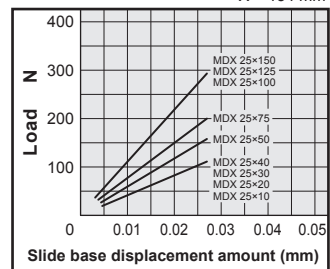

**MSR(L)**  
Slide Table  
Cylinder

**FMR(L)**  
Slide Table  
Cylinder

**MDX**  
Slide Table  
Cylinder

**MDXL**  
Slide Table  
Cylinder

**MQX**  
Compact  
Slide  
Cylinder

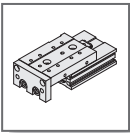

# MDX series - SLIDE TABLE CYLINDER

**New**

External dimension

CHELIC PNEUMATIC

MDX Ø6 ×

MDX 6 ×  ST

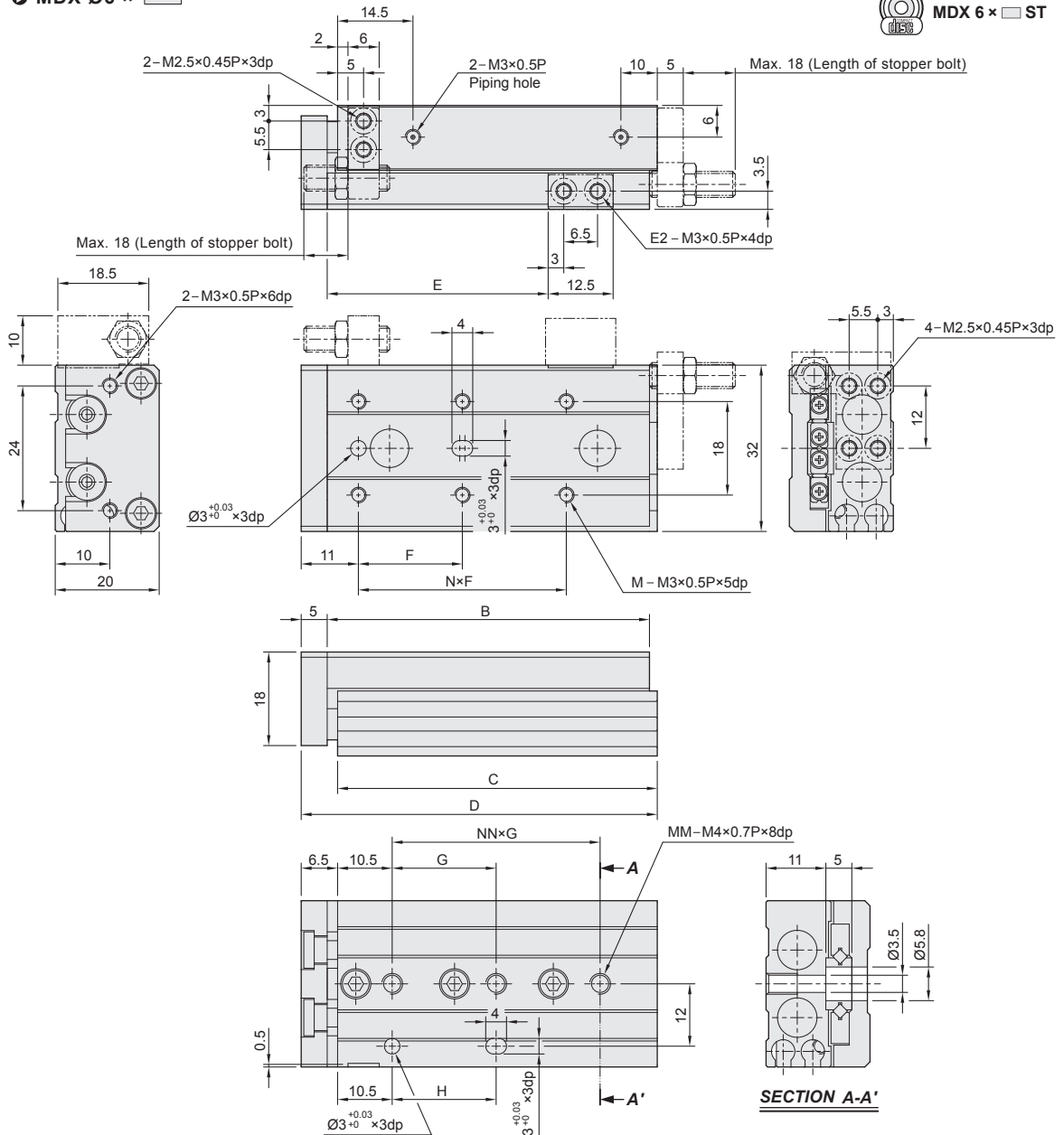

## Dimension

Unit : mm

Code Stroke	B	C	D	E	E <sub>2</sub>	F	N	G	NN	H	M	MM
10	42	41.5	48	22.5	2	20	1	25	1	20	4	2
20	52	51.5	58	32.5	2	30	1	35	1	20	4	2
30	62	61.5	68	42.5	2	20	2	20	2	20	6	3
40	84	83.5	90	52.5	2	28	2	30	2	30	6	3
50	100	99.5	106	62.5	2	38	2	24	3	48	6	4

## Option

Stopper bolt

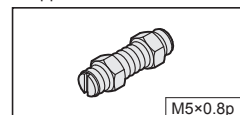



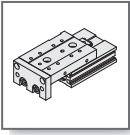

# MDX series - SLIDE TABLE CYLINDER

External dimension

CHELIC PNEUMATIC

MDX Ø8 ×



MDX 8 ×  ST

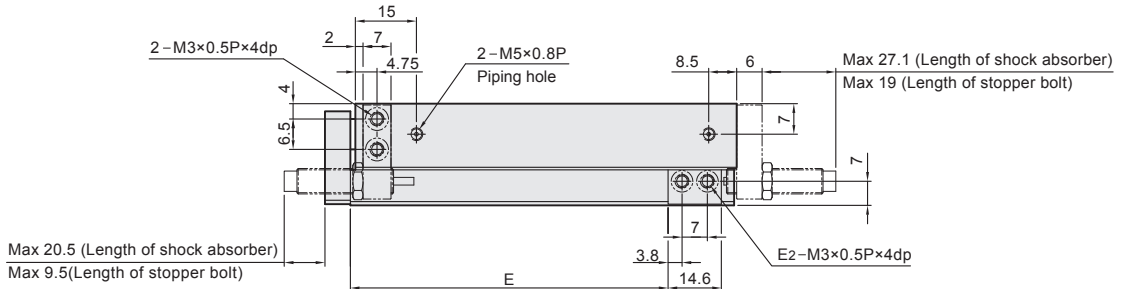

Max 20.5 (Length of shock absorber)  
Max 9.5 (Length of stopper bolt)

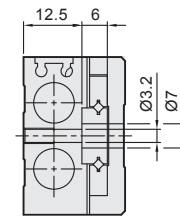
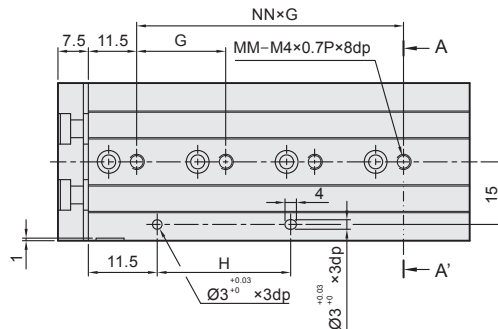
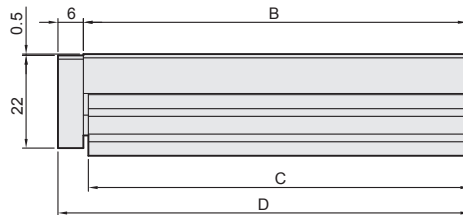
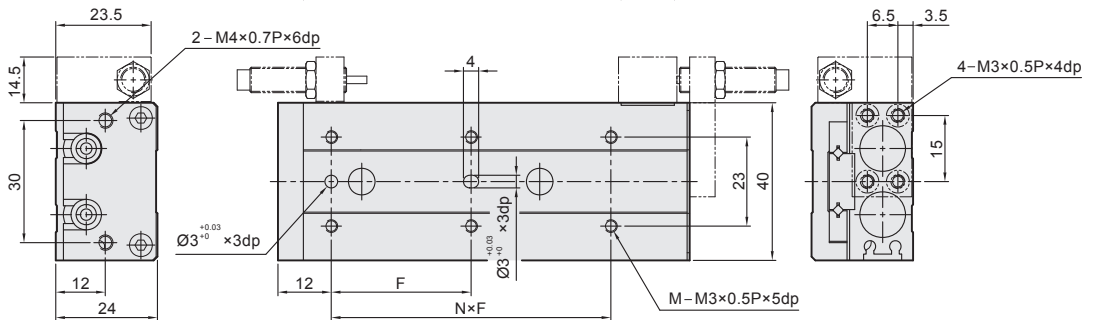

SECTION A-A'

## Dimension

Unit : mm

Code Stroke	B	C	D	E	E <sub>2</sub>	F	N	G	NN	H	M	MM
10	49	48.5	56	23.5	2	25	1	28	1	20	4	2
20	54	53.5	61	33.5	2	25	1	30	1	30	4	2
30	65	64.5	72	43.5	2	40	1	20	2	20	4	3
40	83	82.5	90	53.5	2	50	1	28	2	28	4	3
50	101	100.5	108	63.5	4	38	2	23	3	50	6	4
75	151	150.5	158	88.5	4	50	2	28	4	56	6	5

## Option

Shock absorber

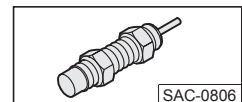

Stopper bolt

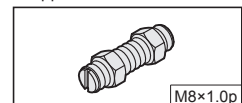

**MSR(L)**  
Slide Table  
Cylinder

**FMR(L)**  
Slide Table  
Cylinder

**MDX**  
Slide Table  
Cylinder

**MDXL**  
Slide Table  
Cylinder

**MQX**  
Compact  
Slide  
Cylinder

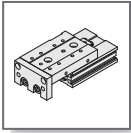

# MDX series - SLIDE TABLE CYLINDER

External dimension

CHELIC PNEUMATIC

MDX Ø12 ×

ST logo"/> MDX 12 ×  ST

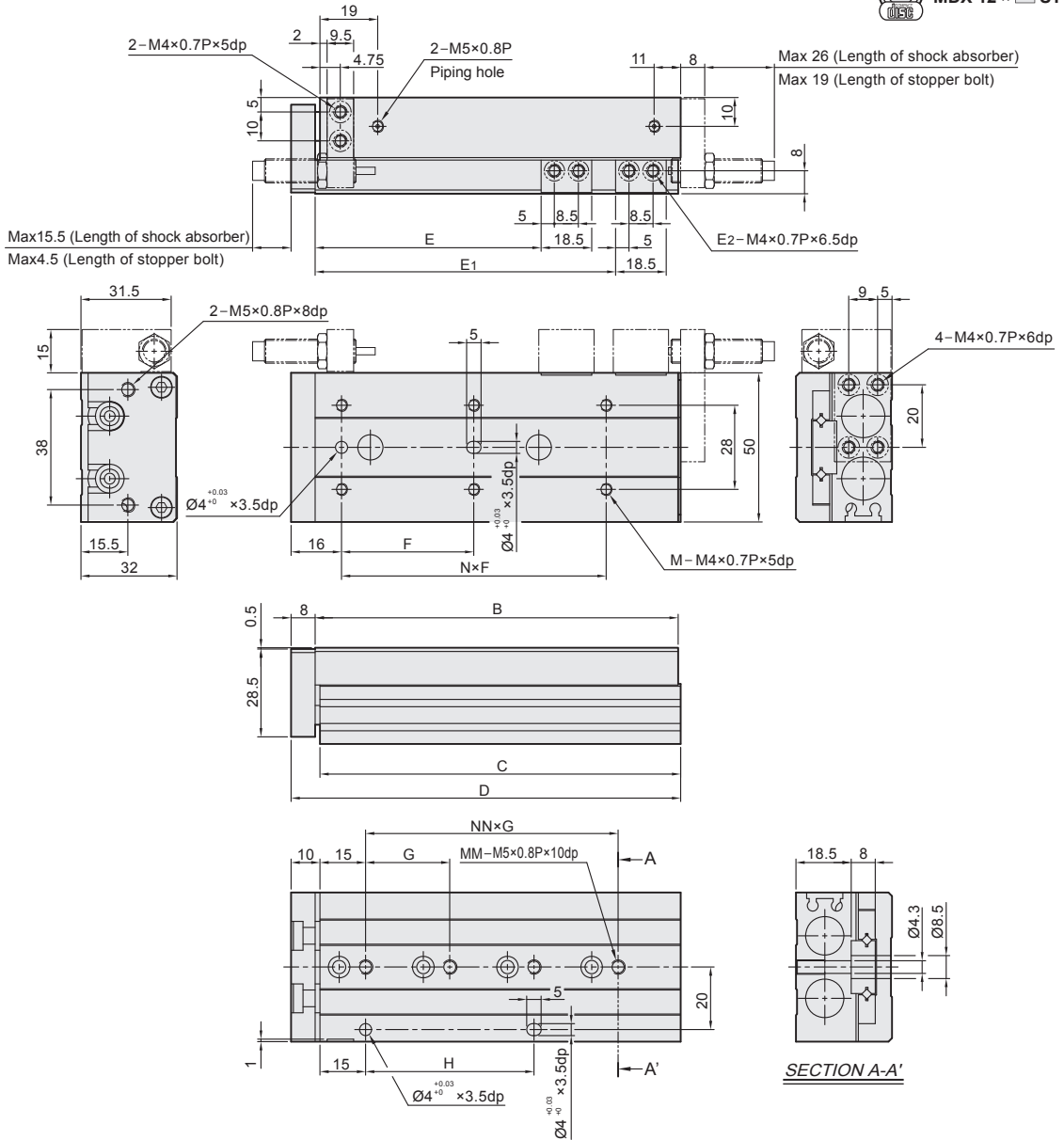

## Dimension

Unit : mm

Code Stroke	B	C	D	E	E <sub>1</sub>	E <sub>2</sub>	F	N	G	NN	H	M	MM
10	71	70	80	26.5	—	2	35	1	40	1	40	4	2
20	71	70	80	36.5	—	2	35	1	40	1	40	4	2
30	71	70	80	46.5	—	2	35	1	40	1	40	4	2
40	83	82	92	56.5	—	2	50	1	25	2	25	4	3
50	103	102	112	66.5	—	2	35	2	36	2	36	6	3
75	149	148	158	91.5	125.5	4	55	2	36	3	72	6	4
100	203	202	212	116.5	179.5	4	65	2	38	4	76	10	5

## Option

Shock absorber

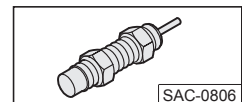

Stopper bolt

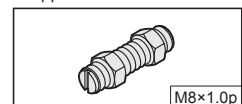

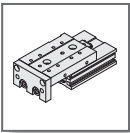

# MDX series - SLIDE TABLE CYLINDER

External dimension

CHELIC PNEUMATIC

MDX Ø16 ×

MDX 16 ×  ST

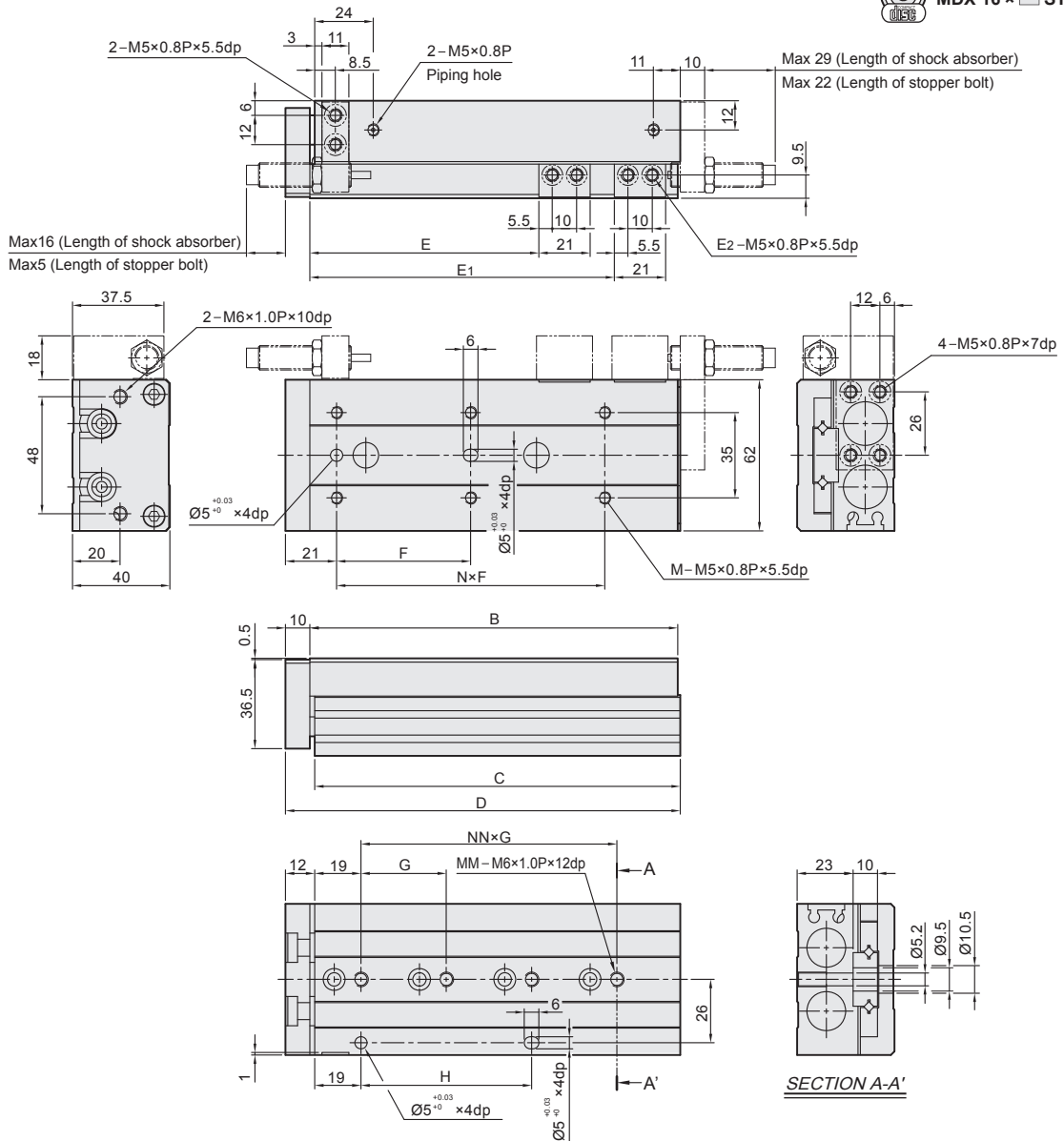

## Dimension

Unit : mm

Code Stroke	B	C	D	E	E <sub>1</sub>	E <sub>2</sub>	F	N	G	NN	H	M	MM
10	76	75	87	29	—	2	35	1	40	1	40	4	2
20	76	75	87	39	—	2	35	1	40	1	40	4	2
30	76	75	87	49	—	2	35	1	40	1	40	4	2
40	86	85	97	59	—	2	50	1	50	1	50	4	2
50	101	100	112	69	—	2	35	2	30	2	30	6	3
75	151	150	162	94	125	4	55	2	35	3	70	6	4
100	199	198	210	119	173	4	65	2	35	4	70	6	5
125	249	248	260	144	223	4	70	2	35	6	70	6	7

## Option

Shock absorber

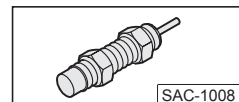

Stopper bolt

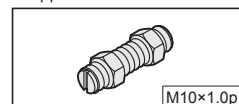

**MSR(L)**  
Slide Table  
Cylinder

**FMR(L)**  
Slide Table  
Cylinder

**MDX**  
Slide Table  
Cylinder

**MDXL**  
Slide Table  
Cylinder

**MQX**  
Compact  
Slide  
Cylinder

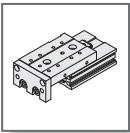

# MDX series - SLIDE TABLE CYLINDER

External dimension

CHELIC PNEUMATIC

MDX Ø20 ×

MDX 20 ×  ST

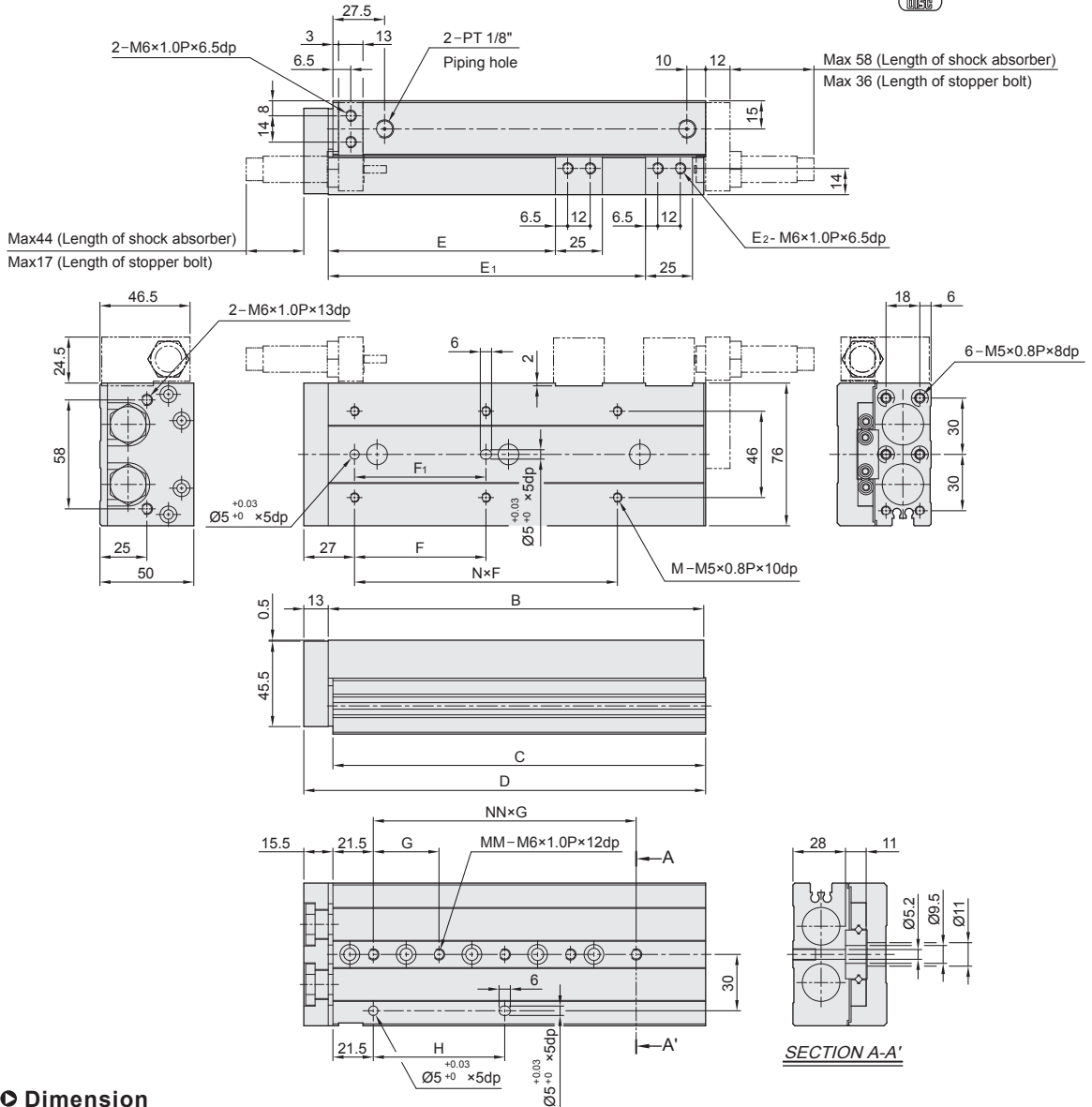

## Dimension

Unit : mm

Code Stroke	B	C	D	E	E <sub>1</sub>	E <sub>2</sub>	F	N	F <sub>1</sub>	G	NN	H	M	MM
10	83	81.5	97	31	—	2	50	1	40	45	1	35	4	2
20	83	81.5	97	41	—	2	50	1	40	45	1	35	4	2
30	83	81.5	97	51	—	2	50	1	40	45	1	35	4	2
40	93	91.5	107	61	—	2	60	1	50	55	1	35	4	2
50	108	106.5	122	71	—	2	35	2	35	35	2	35	6	3
75	147	145.5	161	96	—	2	60	2	60	35	3	70	6	4
100	200	198.5	214	121	168	4	70	2	70	35	4	70	6	5
125	254	252.5	268	146	223	4	80	3	70	38	5	75.5	8	6
150	306	304.5	320	171	275	4	80	3	80	44	6	87.5	8	7

## Option

Shock absorber

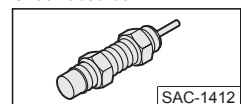

Stopper bolt

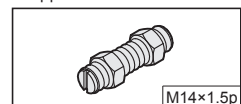

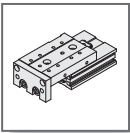

# MDX series - SLIDE TABLE CYLINDER

External dimension

CHELIC PNEUMATIC

MDX Ø25 ×

MDX 25 ×  ST

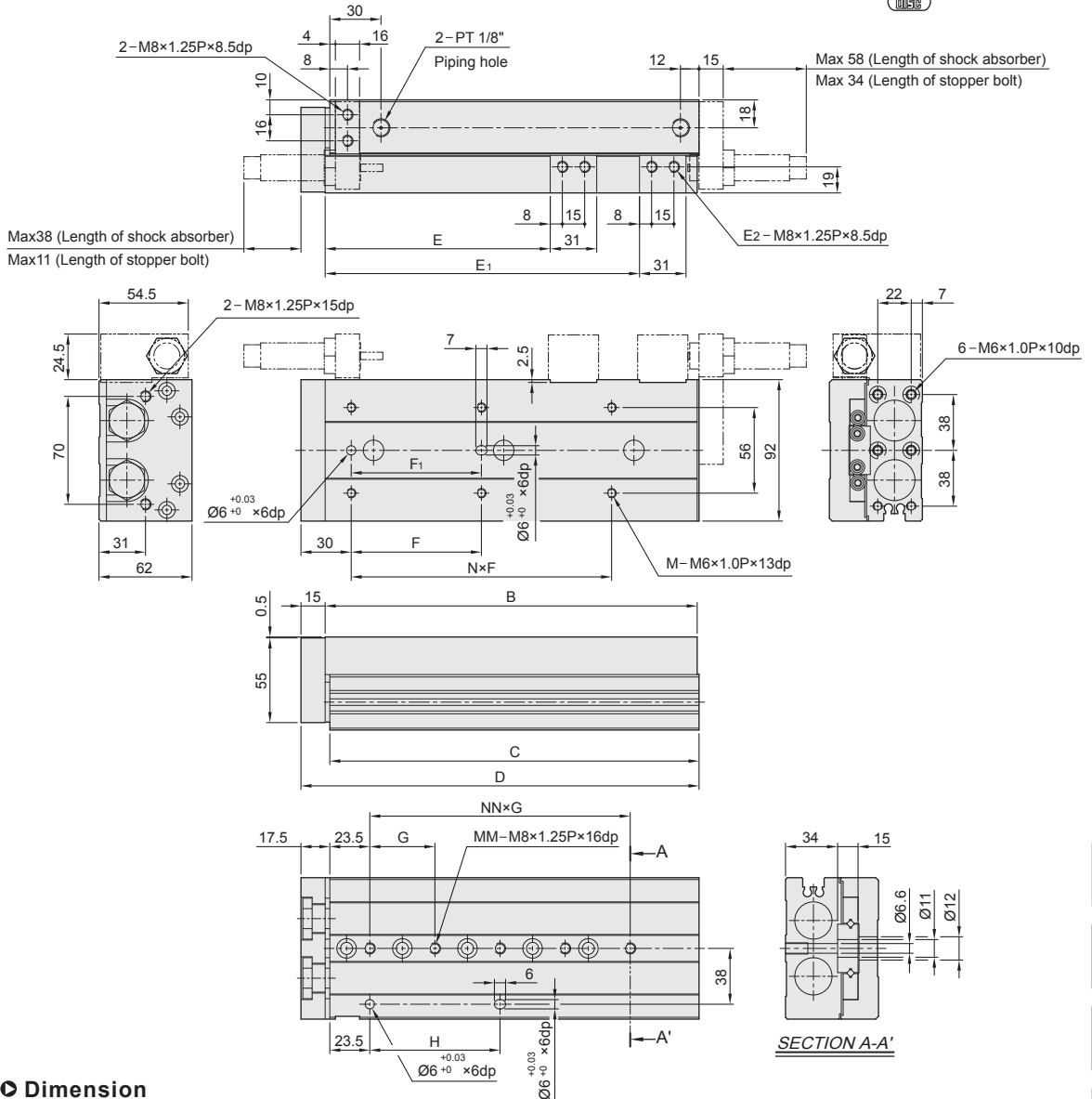

## Dimension

Unit : mm

Code Stroke	B	C	D	E	E <sub>1</sub>	E <sub>2</sub>	F	N	F <sub>1</sub>	G	NN	H	M	MM
10	92	90.5	108	35	—	2	50	1	40	45	1	45	4	2
20	92	90.5	108	45	—	2	50	1	40	45	1	45	4	2
30	92	90.5	108	55	—	2	50	1	40	45	1	45	4	2
40	102	100.5	118	65	—	2	60	1	50	55	1	55	4	2
50	115	113.5	131	75	—	2	35	2	35	35	2	35	6	3
75	156	154.5	172	100	—	2	60	2	60	35	3	70	6	4
100	197	195.5	213	125	162	4	70	2	70	35	4	70	6	5
125	255	253.5	271	150	218	4	75	3	75	38	5	76	8	6
150	295	293.5	311	175	258	4	80	3	80	40	6	80	8	7

## Option

Shock absorber

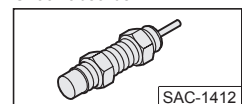

Stopper bolt

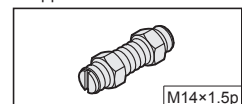

**MSR(L)**  
Slide Table  
Cylinder

**FMR(L)**  
Slide Table  
Cylinder

**MDX**  
Slide Table  
Cylinder

**MDXL**  
Slide Table  
Cylinder

**MQX**  
Compact  
Slide  
Cylinder

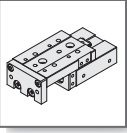

# MDXL series - SLIDE TABLE CYLINDER

**New**

External dimension

CHELIC PNEUMATIC

MDXL Ø6 ×

MDXL 6 ×  ST

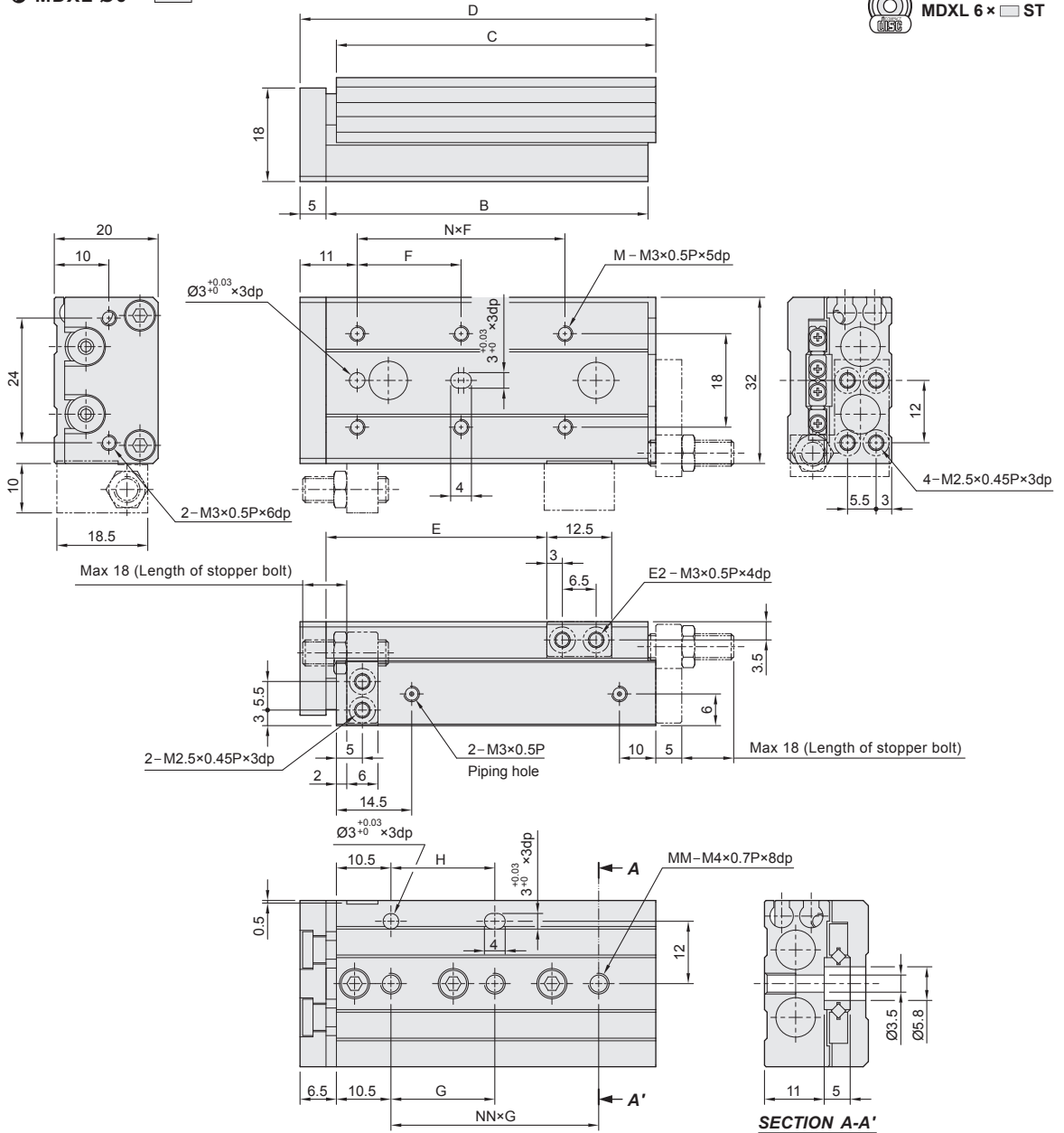

## Dimension

Unit : mm

Code Stroke	B	C	D	E	E <sub>2</sub>	F	N	G	NN	H	M	MM
10	42	41.5	48.5	22.5	2	20	1	25	1	20	4	2
20	52	51.5	58.5	32.5	2	30	1	35	1	20	4	2
30	62	61.5	68.5	42.5	2	20	2	20	2	20	6	3
40	84	83.5	70	52.5	2	28	2	30	2	30	6	3
50	100	99.5	106	62.5	2	38	2	24	3	48	6	4

## Option

Stopper bolt

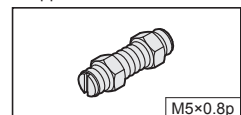

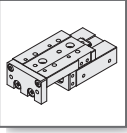

# MDXL series - SLIDE TABLE CYLINDER

**new**

External dimension

CHELIC PNEUMATIC

MDXL Ø6 ×

MDXL 6 ×  ST

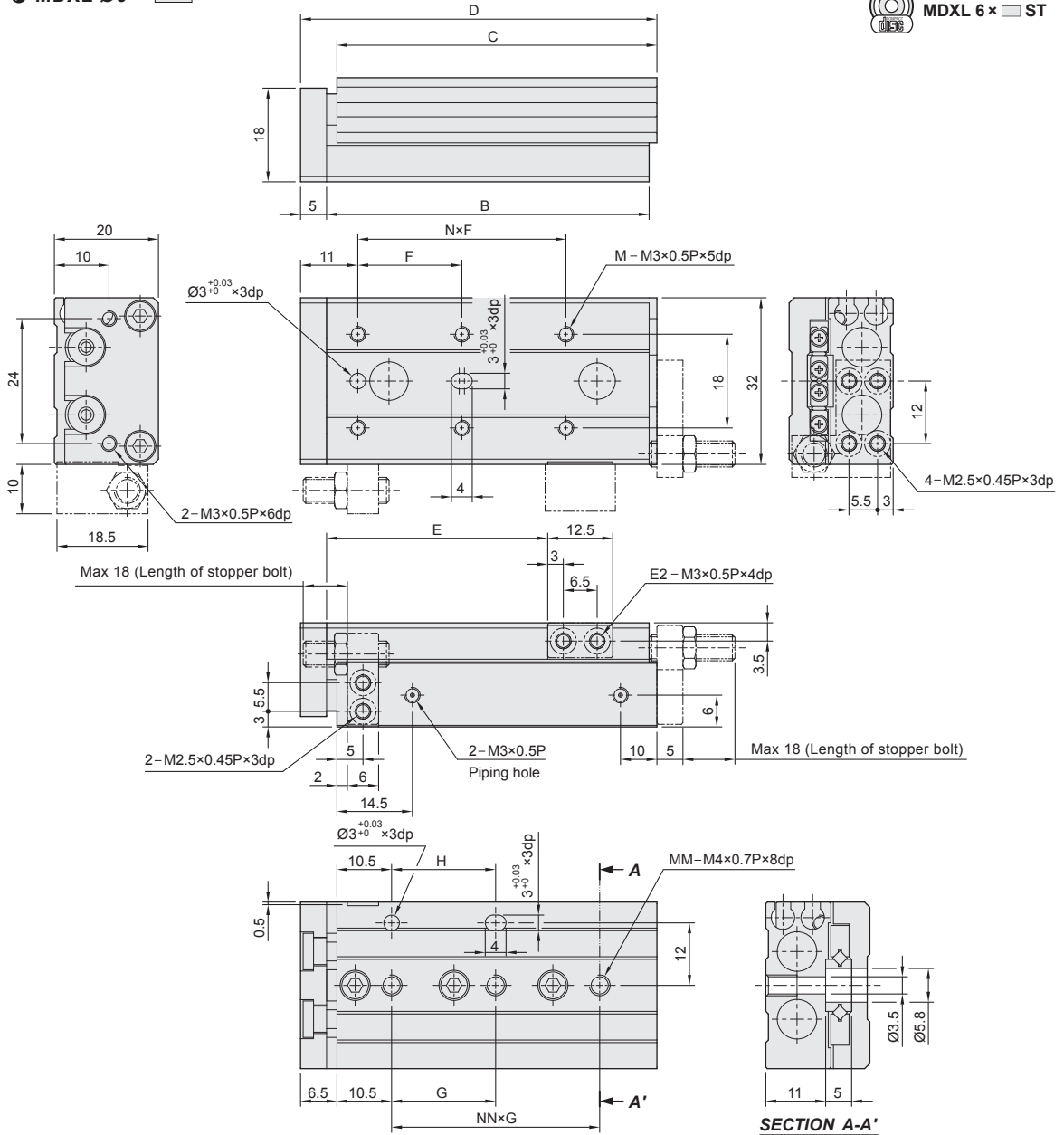

## Dimension

Unit : mm

Code Stroke	B	C	D	E	E <sub>2</sub>	F	N	G	NN	H	M	MM
10	42	41.5	48	22.5	2	20	1	25	1	20	4	2
20	52	51.5	58	32.5	2	30	1	35	1	20	4	2
30	62	61.5	68	42.5	2	20	2	20	2	20	6	3
40	84	83.5	90	52.5	2	28	2	30	2	30	6	3
50	100	99.5	106	62.5	2	38	2	24	3	48	6	4

## Option

Stopper bolt

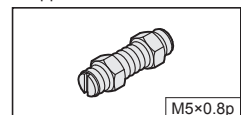

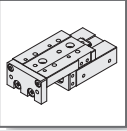

# MDXL series - SLIDE TABLE CYLINDER

**new**

External dimension

CHELIC PNEUMATIC

MDXL Ø8 ×



MDXL 8 ×  ST

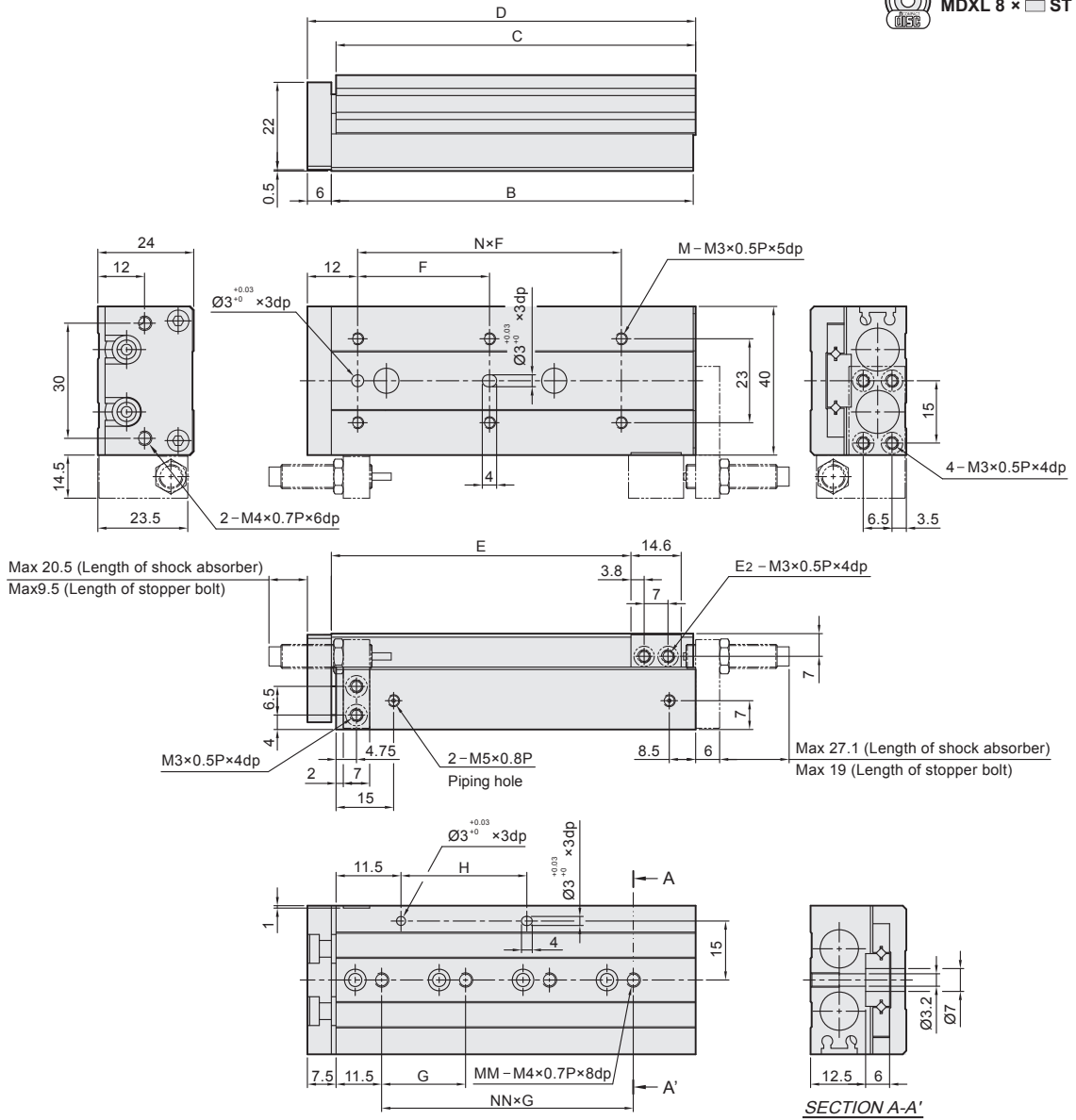

**MSR(L)**  
Slide Table  
Cylinder

**FMR(L)**  
Slide Table  
Cylinder

**MDX**  
Slide Table  
Cylinder

**MDXL**  
Slide Table  
Cylinder

**MQX**  
Compact  
Slide  
Cylinder

## Option

Shock absorber

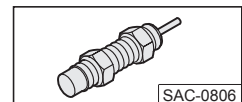

Stopper bolt

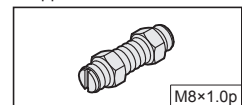

## Dimension

Unit : mm

Code Stroke	B	C	D	E	E <sub>2</sub>	F	N	G	NN	H	M	MM
10	49	48.5	56	23.5	2	25	1	28	1	20	4	2
20	54	53.5	61	33.5	2	25	1	30	1	30	4	2
30	65	64.5	72	43.5	2	40	1	20	1	20	4	3
40	83	82.5	90	53.5	2	50	1	28	2	28	4	3
50	101	100.5	108	63.5	4	38	2	23	3	50	6	4
75	151	150.5	158	88.5	4	50	2	28	4	56	6	5



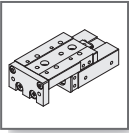

# MDXL series - SLIDE TABLE CYLINDER

**NEW**

External dimension

CHELIC PNEUMATIC

MDXL Ø12 ×

MDXL 12 ×  ST

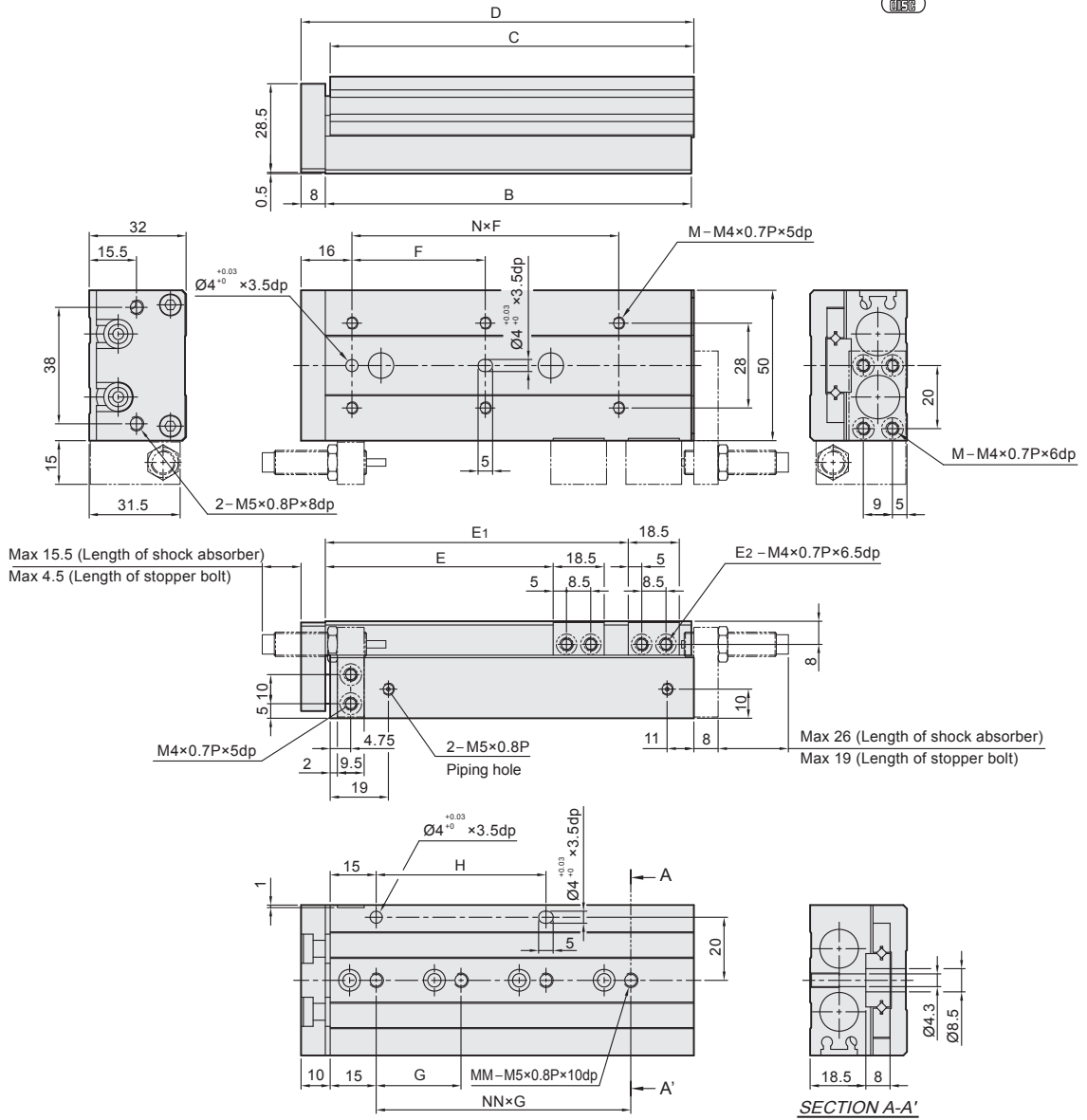

## Dimension

Unit : mm

Code Stroke	B	C	D	E	E <sub>1</sub>	E <sub>2</sub>	F	N	G	NN	H	M	MM
10	71	70	80	26.5	—	2	35	1	40	1	40	4	2
20	71	70	80	36.5	—	2	35	1	40	1	40	4	2
30	71	70	80	46.5	—	2	35	1	40	1	40	4	3
40	83	82	92	56.5	—	2	50	1	25	2	25	4	3
50	103	102	112	66.5	—	2	35	2	36	2	36	6	3
75	149	148	158	91.5	125.5	4	55	2	36	3	72	6	4
100	203	202	212	116.5	179.5	4	65	2	38	4	76	10	5

## Option

Shock absorber

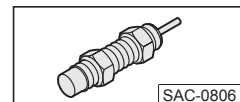

Stopper bolt

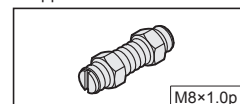

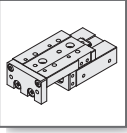

# MDXL series - SLIDE TABLE CYLINDER

**New**

External dimension

CHELIC PNEUMATIC

MDXL Ø16 ×

MDXL 16 ×  ST

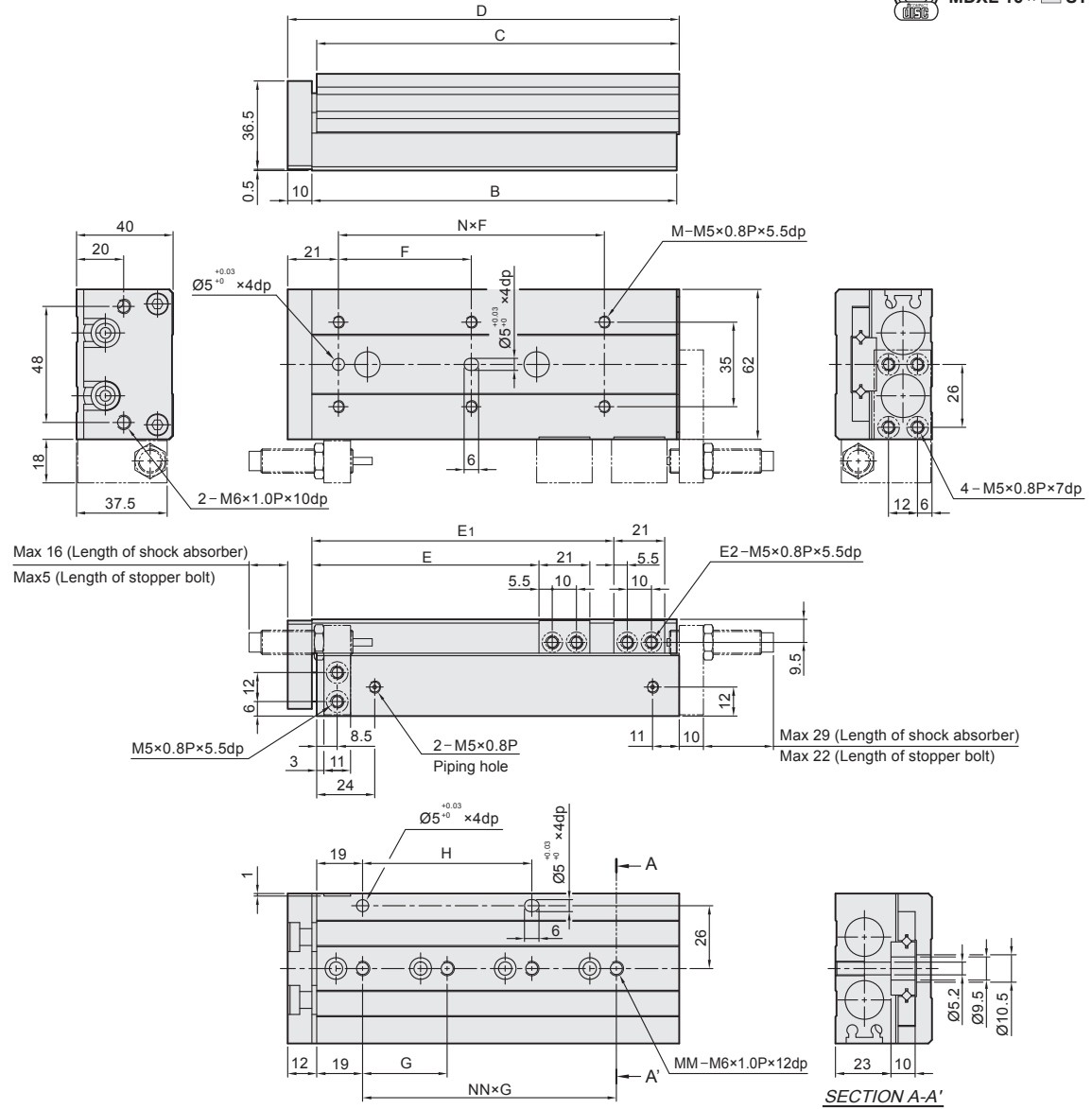

## Dimension

Unit : mm

Code Stroke	B	C	D	E	E <sub>1</sub>	E <sub>2</sub>	F	N	G	NN	H	M	MM
10	76	75	87	29	—	2	35	1	40	1	40	4	2
20	76	75	87	39	—	2	35	1	40	1	40	4	2
30	76	75	87	49	—	2	35	1	40	1	40	4	3
40	86	85	97	59	—	2	50	1	50	1	50	4	3
50	101	100	112	69	—	2	35	2	30	2	30	6	3
75	151	150	162	94	125	4	55	2	35	3	70	6	4
100	199	198	210	119	173	4	65	2	35	4	70	6	5
125	249	248	260	144	223	4	70	2	35	6	70	6	7

## Option

Shock absorber

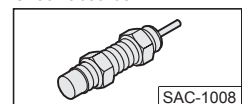

Stopper bolt

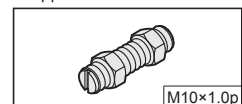

**MSR(L)**  
Slide Table  
Cylinder

**FMR(L)**  
Slide Table  
Cylinder

**MDX**  
Slide Table  
Cylinder

**MDXL**  
Slide Table  
Cylinder

**MQX**  
Compact  
Slide  
Cylinder

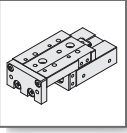

# MDXL series - SLIDE TABLE CYLINDER

**New**

External dimension

CHELIC PNEUMATIC

MDXL Ø20 ×

MDXL 20 ×  ST

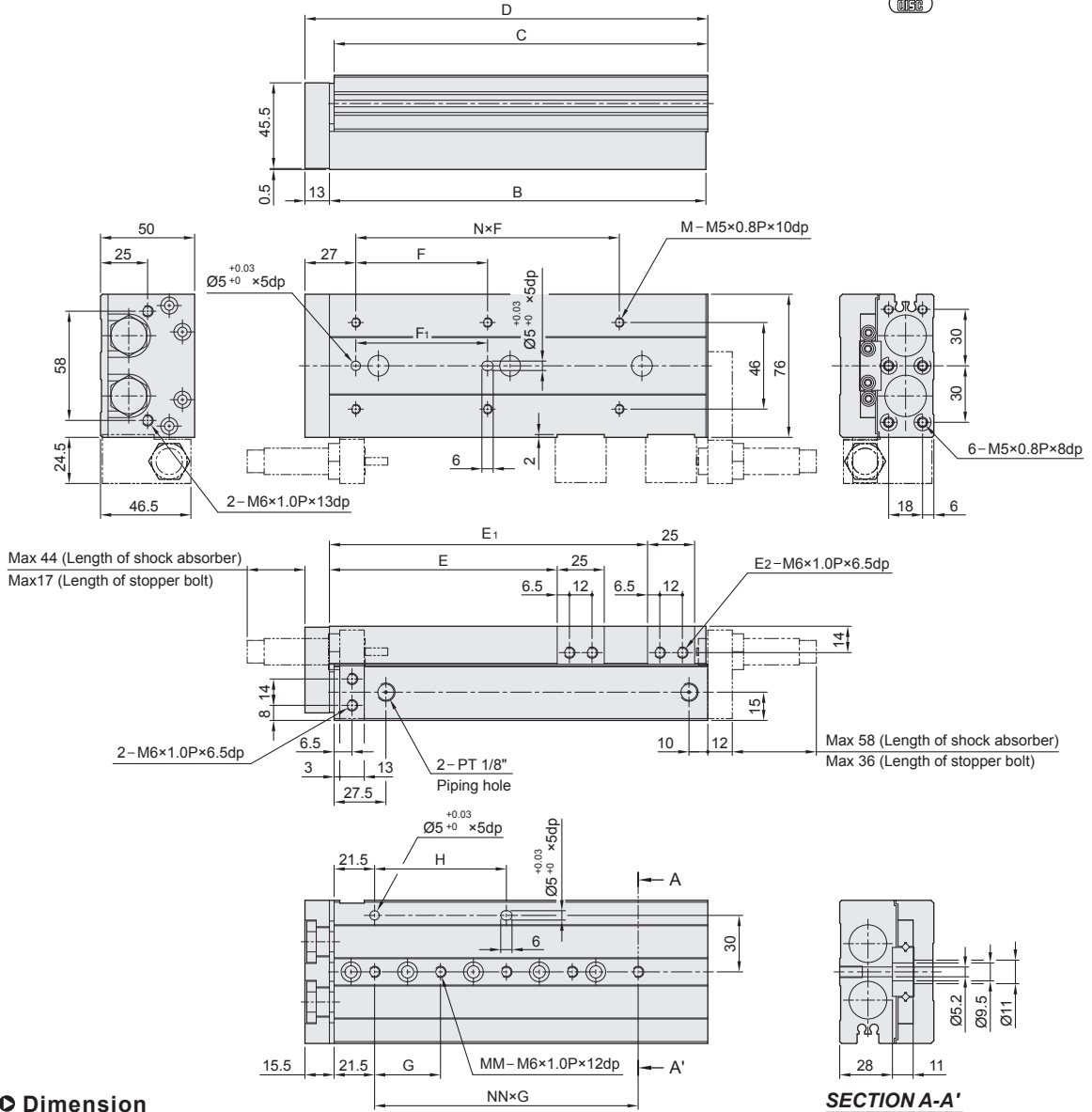

**SECTION A-A'**

**Dimension**

Unit : mm

Code Stroke	B	C	D	E	E <sub>1</sub>	E <sub>2</sub>	F	N	F <sub>1</sub>	G	NN	H	M	MM
10	83	81.5	97	31	—	2	50	1	40	45	1	35	4	2
20	83	81.5	97	41	—	2	50	1	40	45	1	35	4	2
30	83	81.5	97	51	—	2	50	1	40	45	1	35	4	2
40	93	91.5	107	61	—	2	60	1	50	55	1	35	4	2
50	108	106.5	122	71	—	2	35	2	35	35	2	35	6	3
75	147	145.5	161	96	—	2	60	2	60	35	3	70	6	4
100	200	198.5	214	121	168	4	70	2	70	35	4	70	6	5
125	254	252.5	268	146	223	4	80	3	70	38	5	75.5	8	6
150	306	304.5	320	171	275	4	80	3	80	44	6	87.5	8	7

**Option**

Shock absorber

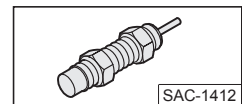

Stopper bolt

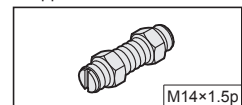

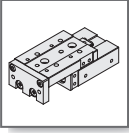

# MDXL series - SLIDE TABLE CYLINDER

**New**

External dimension

CHELIC PNEUMATIC

MDXL Ø25 ×

 MDXL 25 ×  ST

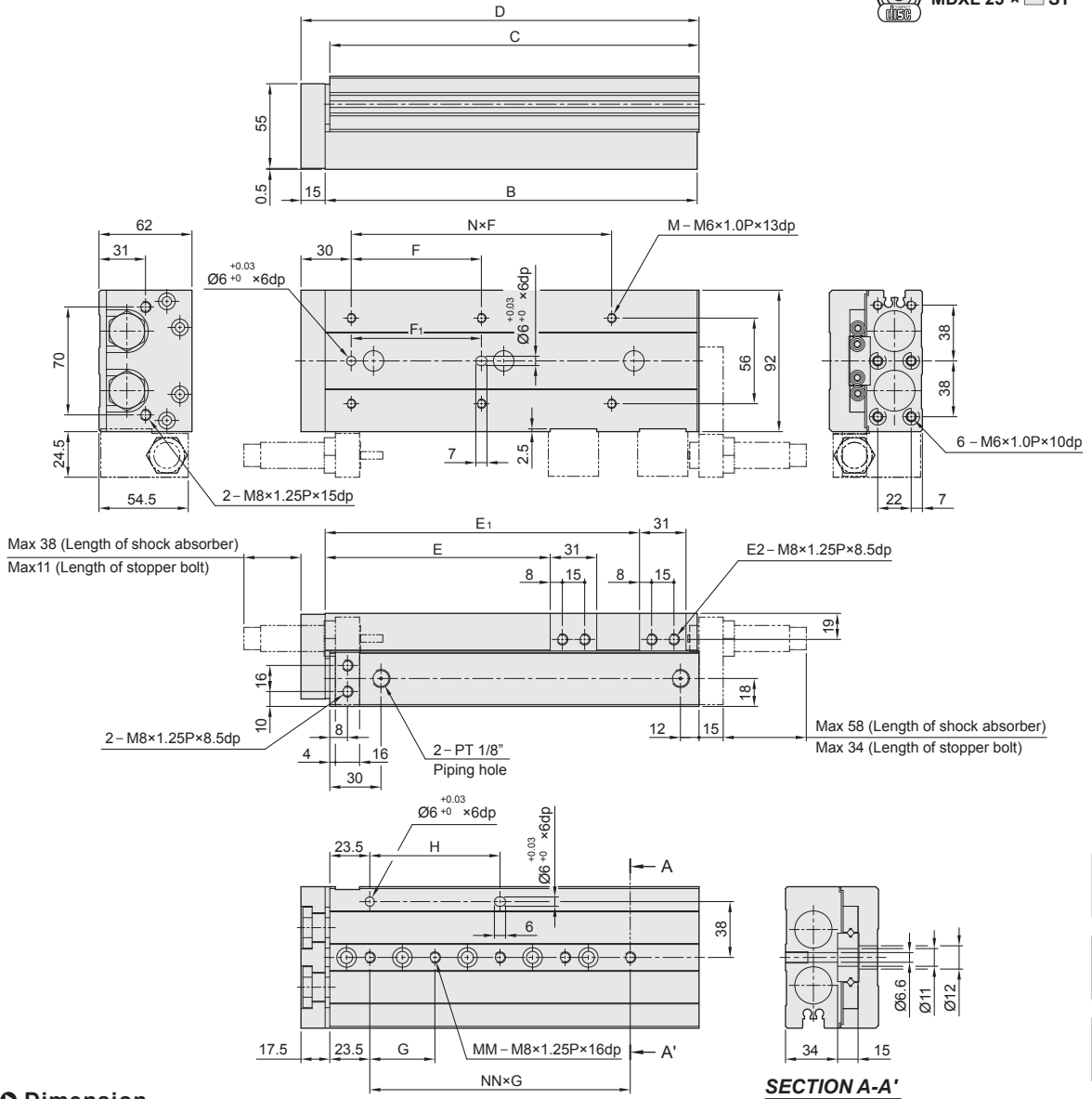

## Dimension

Unit : mm

Code Stroke	B	C	D	E	E <sub>1</sub>	E <sub>2</sub>	F	N	F <sub>1</sub>	G	NN	H	M	MM
10	92	90.5	108	35	—	2	50	1	40	45	1	45	4	2
20	92	90.5	108	45	—	2	50	1	40	45	1	45	4	2
30	92	90.5	108	55	—	2	50	1	40	45	1	45	4	2
40	102	100.5	118	65	—	2	60	1	50	55	1	55	4	2
50	115	113.5	131	75	—	2	35	2	35	35	2	35	6	3
75	156	154.5	172	100	—	2	60	2	60	35	3	70	6	4
100	197	195.5	213	125	162	4	70	2	70	35	4	70	6	5
125	255	253.5	271	150	218	4	75	3	75	38	5	76	8	6
150	295	293.5	311	175	258	4	80	3	80	40	6	80	8	7

## Option

Shock absorber

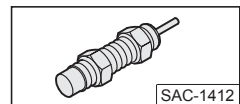

Stopper bolt

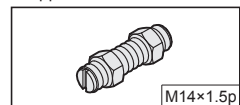

**MSR(L)**  
Slide Table  
Cylinder

**FMR(L)**  
Slide Table  
Cylinder

**MDX**  
Slide Table  
Cylinder

**MDXL**  
Slide Table  
Cylinder

**MQX**  
Compact  
Slide  
Cylinder

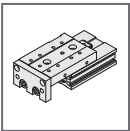

# MDX(L) series - SLIDE TABLE CYLINDER

Stroke adjustment and Shock absorber installation

CHELIC PNEUMATIC

## Stroke adjustment and With shock absorber

– [A] With shock absorber

- MDX / MDXL  
External drawing

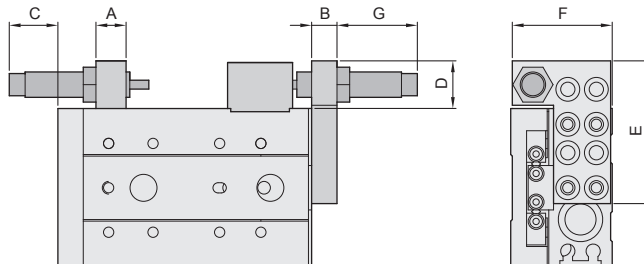
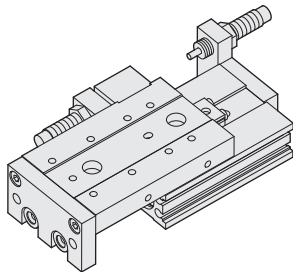

Code	A	B	C	D	E	F	G						
Dimensions							10ST	20ST	30ST	40ST	50ST	75ST	100ST
Model													
MDX(L) Ø8	7	8	20.8	14.5	38	23.5	20.1	25.1	24.1	—	—	—	—
MDX(L) Ø12	9.5	8	15.5	15	45	31.5	5	15	25	23	13	26	—
MDX(L) Ø16	11	10	16	18	55	37.5	8	18	28	28	23	29	29
MDX(L) Ø20	13	12	44	24.5	70	47.5	38	48	58	58	53	39	59
MDX(L) Ø25	16	15	38	24.5	80	54.5	36	46	56	56	53	37	58

– [B] With stopper bolt

- MDX / MDXL  
External drawing

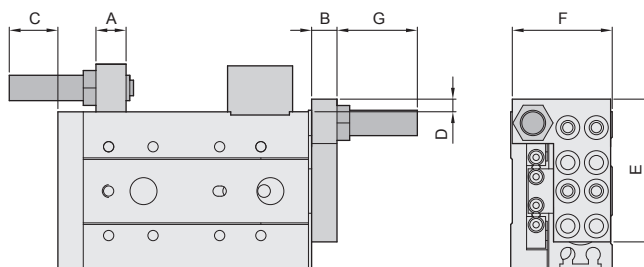
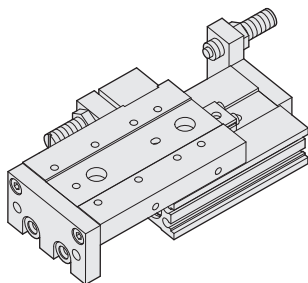

Code	A	B	C	D	E	F	G	Stroke adjustment
Dimensions								
Model								
MDX(L) Ø6	6	5	11.5	2.5	22.5	19	21.3	0 ~ 18 mm
MDX(L) Ø8	7	8	20.8	14.5	38	23.5	19	0 ~ 15 mm
MDX(L) Ø12	9.5	8	15.5	15	45	31.5	19	0 ~ 15 mm
MDX(L) Ø16	11	10	16	18	55	37.5	22	0 ~ 20 mm
MDX(L) Ø20	13	12	44	24.5	70	47.5	37	0 ~ 30 mm
MDX(L) Ø25	16	15	38	24.5	80	54.5	34	0 ~ 30 mm

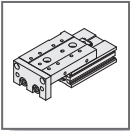

# MDX(L) series - SLIDE TABLE CYLINDER

Sensor switch installation and Sensing setting

CHELIC PNEUMATIC

## ◉ Sensor switch installation

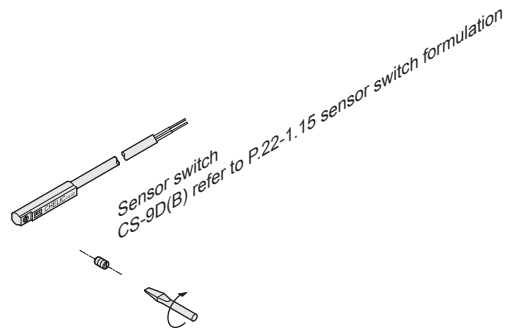
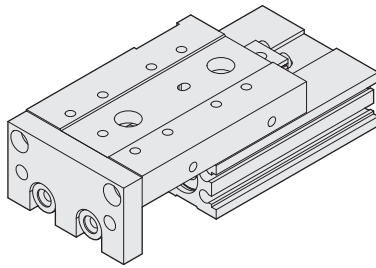

## ◉ Operating range

Sensor switch is fixed on the cylinder body. The magnetic piston head will activate the Sensor switch when it enters the operating range. It has 0.5mm differential.

## ◉ Setting range

When piston head moves the switch setting and adjustment will be based on the responding range generated by the magnetic field and the switch. (Please refer to the below table)

## ◉ Sensor switch setting and operating range

### ● CS - 9D (B)

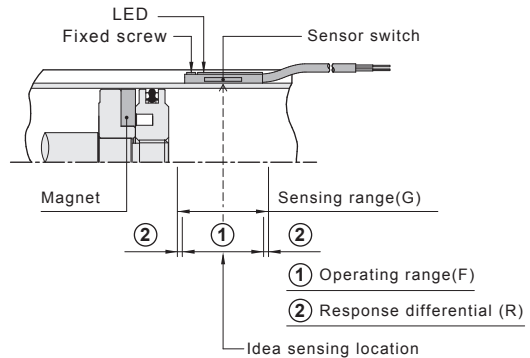

Unit : mm

Model	CS-8G		CS-9D(B)	
Bore size	Operating range (F)	Response differential(R)	Operating range (F)	Response differential(R)
Ø6	4	1	—	—
Ø8	2.5	1	—	—
Ø12	4.5	1	8	1
Ø16	5.3	1.2	10	1.2
Ø20	5.3	1.2	11	1.2
Ø25	5.7	1.5	9	1.5

## ◉ Connector type

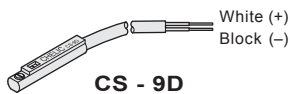

**CS - 9D**

Voltage : DC 5 ~ 120 V  
AC 5 ~ 120 V

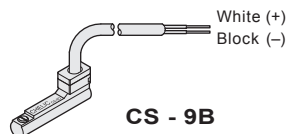

**CS - 9B**

Voltage : DC 5 ~ 120 V  
AC 5 ~ 120 V

**MSR(L)**  
Slide Table  
Cylinder

**FMR(L)**  
Slide Table  
Cylinder

**MDX**  
Slide Table  
Cylinder

**MDXL**  
Slide Table  
Cylinder

**MQX**  
Compact  
Slide  
Cylinder

