

Part number

# M7P 06 L20



## Brief description:

surface mounting housings with single lever, size "44.27", M20, metal version, IP66/ IP67

### Product description

<b>Version</b>	C7 - CV and M7 - MV enclosures, V-Type lever version
<b>Series</b>	Surface mounting housings with 1 lever
<b>Product type</b>	with stainless steel lever
<b>Family</b>	C7 - CV and M7 - MV enclosures, V-Type lever version
<b>Size</b>	size "44.27"

### Technical data

<b>Operating temperature range (min, max)</b>	-40 °C...+125 °C
<b>Material</b>	metal
<b>IP degree of protection</b>	IP66/ IP67 (EN 60529) and IP69K (DIN 40050 - 9) degree of protection.
<b>Cable entry</b>	M20

### Further technical details

<b>Weight</b>	197,00 g
---------------	----------

### Approvals / Standards

<b>Quality mark</b>	 (type:4/4X/12),  , EAC
<b>Conformity</b>	CQC, CE

### General ordering information

<b>EAN13 code</b>	8015747093606
<b>Tariff number</b>	85369095

### Packaging Information

<b>Packaging length</b>	285,00 mm
<b>Packaging height</b>	170,00 mm
<b>Packaging width</b>	190,00 mm
<b>Packaging weight</b>	7,94 kg
<b>Packaging volume</b>	9,21 dm <sup>3</sup>
<b>Packaging description</b>	Carton box
<b>Packaging quantity</b>	20 Pcs
<b>Packaging EAN code</b>	8015747178259
<b>Sub-packaging weight</b>	1,99 kg
<b>Sub-packaging description</b>	Plastic packaging
<b>Sub-packaging quantity</b>	5 Pcs
<b>Sub-packaging EAN barcode</b>	8015747178266

Part number

# M7P 06 L20



## Catalogue drawings

C7P L - C7AP L M7P L - M7AP L

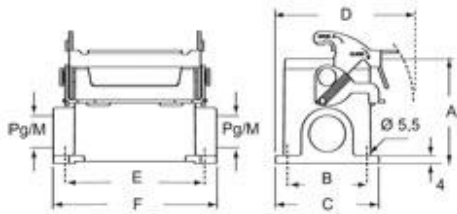

	A	B	C	D	E	F
C7P/M7P 06 L	53	40	52	70	70	82
C7AP/M7AP 06 L	73	45	57	72,5	70	82

## Notes

### C7P/M7P:

Due to the vertical closing movement, the new lever offers an IP66/IP67 protection (according to EN 60529) when fitted with a complete and coupled connector and used with ILME standard hoods in die cast aluminum with pegs (without adaptor).