

SAFETY LIGHT CURTAINS

JANUS J TRX - 2B TRX

Models, without built-in Muting Function. They are composed of an active element and of a passive retro-reflector element. Ideal solutions for all applications in which it is difficult or costly to cable electrical lines.

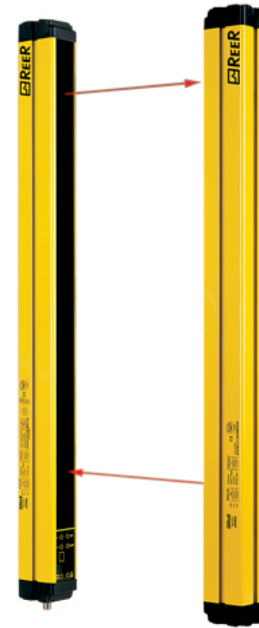

Certifications:



Technical data:

Family	JANUS J TRX -
Code	1360650
Safety level (SIL / PL)	Type 4 - SIL 3 - SILCL 3 - PL e - Cat. 4
Overall height passive element (mm)	723
Height of protected area (mm)	510
Detection	Access control
Number of beams	2
Max. length of the connection cables (m)	100
Connections	M12 - 8 poles Connector
Operating Range (m)	Up to 6
Power supply (VDC)	24 ± 20%
Response time (ms)	7
Safety outputs	2 fail-safe PNP - 500 mA at 24 VDC with protection against short circuit, overload and reverse polarity
Safety functions	Integrated
Restart	User-selectable automatic or manual
Muting Function	With external modules
Blanking function	No
system MTTFd (ISO 13849-1) years	100
PFHd (IEC 61508)	4,83E-09
CCF (ISO 13849-1)	80%
Degree of protection	IP 65
Operating temperature (°C)	From -10 to 55
Cross section dimensions (mm)	50 x 60
Overall height (mm)	741
Packaging dimensions W x H x L (mm)	195 x 135 x 830
Gross weight (Kg)	5,4
Enclosures	None
Master Slave Models	no

Accessories:

[CABLES C8D 5](#)
[CABLES C8D 10](#)
[CABLES C8D 15](#)
[CABLES C8D 25](#)
[CABLES C8D 40](#)
[CABLES C8D 95](#)
[CABLES C8B 910](#)
[CABLES C8D 915](#)
[CABLES C8D 5 SB](#)
[CABLES C8D 10 SB](#)
[CABLES C8D 15 SB](#)
[CABLES C8D 70](#)
[CABLES C8DM 11](#)
[CABLES C8DM 911](#)
[CABLES C8DM 9](#)
[CABLES C8DM 99](#)
[FMC B2](#)
[FMC S2](#)
[FMC SB2](#)
[FMC B2R](#)
[LASER ALIGNMENT LAD 3](#)
[ACCESSORIES BRACKETS SFB 4J](#)
[ACCESSORIES SP 600 S](#)

Related products:

[MOSAIC MR2](#)
[Safety relay modules AD SR0 - For devices with integrated EDM](#)
[Safety relay modules AD SR0A - For devices with integrated EDM](#)

See technical drawing in the next page.

Technical drawing:

B = 723 mm
A = 741 mm

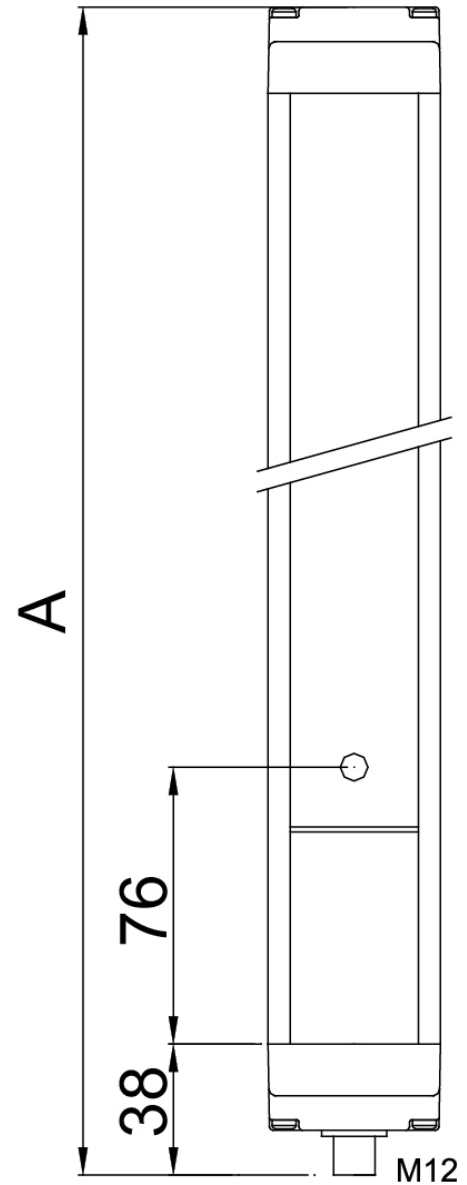
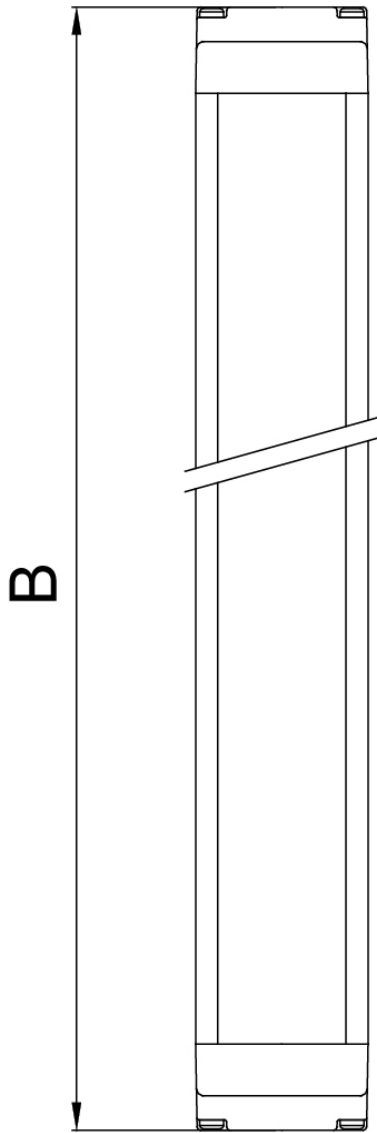
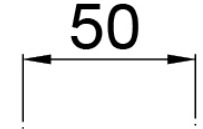
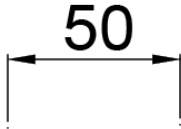
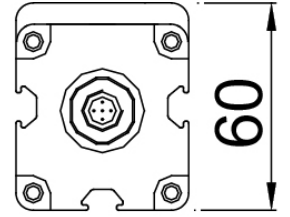
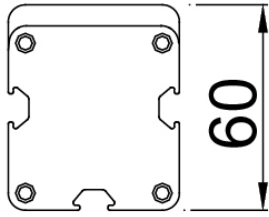

Passive Element

Active Element