

A

A•S1



Steel plunger



Steel plunger with rubber gasket

Contact element		
1NO+1NC snap action  13 21 14 22	00	
1NO+1NC slow action  21 13 22 14	01	
1NO+1NC slow overlap.  25 17 26 18	02	
2NO slow action  13 23 14 24	03	
2NC slow action  11 21 12 22	04	
2NC snap action  11 21 12 22	05	
Weight	kg	0,11
Pack	pcs	1

standard article

Cable entry				
PG 13,5	M20 x 1,5			
Metal head Plastic body	Metal head Plastic body	Contact travel		
E20000AI	E20100AI			
E20001AI	E20101AI			
E20002AI	E20102AI			
E20003AI	E20103AI			
E20004AI	E20104AI			
E20005AI	E20105AI			
		0,11		
		1		

Cable entry				
PG 13,5	M20 x 1,5			
Metal head Plastic body	Metal head Plastic body	Contact travel		
E20000AIS1	E20100AIS1			
E20001AIS1	E20101AIS1			
E20002AIS1	E20102AIS1			
E20003AIS1	E20103AIS1			
E20004AIS1	E20104AIS1			
E20005AIS1	E20105AIS1			
		0,11		
		1		

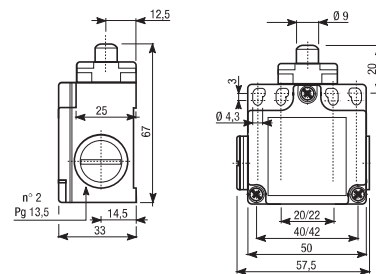
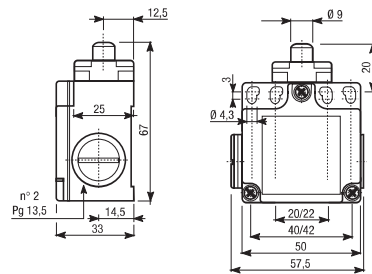

Drive cam operating parameters

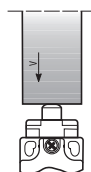

V max (m/s)	0,5
Drive forces	
Minimum command force	9 N
Minimum forced opening force	28 N