

Xenon Helideck Floodlight

Series TEF 9964

TRANBERG®

STAHL



- > Floodlight lights for helideck landing area
- > For use in hazardous areas
- > Rugged and low profile floodlight in acid resistant stainless steel housing (SS316L)
- > Simple to install and maintain
- > Degree of protection IP66 / IP67
- > Resistant to vibrations
- > Long lamp life

E2

www.stahl.de



06370E00



	ATEX					
Zone	0	1	2	20	21	22
For use in		x	x			

Applications

- Floodlights for helideck landing area
- For use in hazardous areas

Explosion protection

Marking

Europe (ATEX) | II 2 G EEx de IIC T5

Certificates

Europe (ATEX) | NEMKO 00ATEX245
Other certificates | Canada (CSA)

WebCode T9964A

Xenon Helideck Floodlight

Series TEF 9964



Selection Table

Version	Description	Order number	Weight kg
Helideck floodlight Xenon EEx de Series TEF 9964	EEx de II T5 - 24 V DC	TEF9964024	12.500
	EEx de II T5 - 110 V AC 50 / 60 Hz	TEF9964010	12.500
	EEx de II T5 - 230 V AC 50 / 60 Hz	TEF9964030	12.500
	EEx de II T5 - 254 V AC 50 / 60 Hz	TEF9964000	12.500

Technical Data

Electrical Data

Rated voltage	24 V DC 110 V AC 50 / 60 Hz 230 V AC 50 / 60 Hz 254 V AC 50 / 60 Hz
Power consumption	50 W

Luminous characteristics

Lamp	Xenon D2S 35 W
------	----------------

Ambient Conditions

Ambient temperature	- 20 ... + 40 °C
---------------------	------------------

Mechanical Data

Degree of protection	IP66 / IP67
Material	
Enclosure	Acid proof stainless steel
Protective glass	Safety glass
Cable glands	E204; Increased safety, EEx e II; cable diam. 11 ... 17.1 mm

Accessories and Spare Parts

Designation	Description	Order number
Light source	Xenon Lamp; D2S, 35 W, 85 V	TEF9400074
Transformer	with mounting bracket; 230 V / 254 V AC	TEF4386
Hookspanner	for TEF 9964 EEx de version	TEF51999016

Dimensional Drawings (All Dimensions in mm) - Subject to Alterations

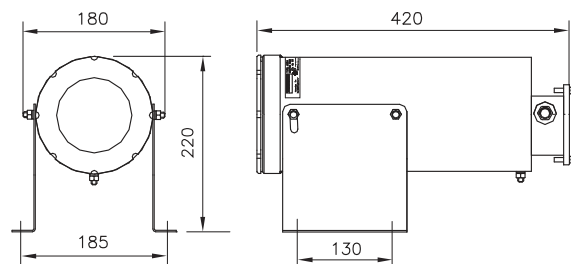

06340E00

We reserve the right to make alterations to the technical data, dimensions, weights, designs and products available without notice. The illustrations cannot be considered binding.