

# unidirectional pump - series WV

WV-OP

STANDARD PUMP W/ BODY INLET AND OUTLET  
 1/2" FLANGE - PARALLEL SHAFT



Model	WV	Series WV
Group	U	group U
Category	P	unidirectional pump
Classification	DA	078
Shaft rotation		622 right rotation
Shaft		CG01 - Parallel of DIN 54-KEY 1/8, 2
Body		Inlet - 1/4" GAS
Outlet		Outlet - 1/4" GAS
Cover	A	standard

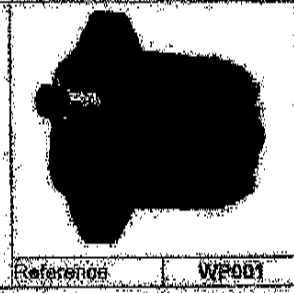

Reference WV001

TYPE	Displacement cm <sup>3</sup> /rev	Max. Pressure		CODE	
		PSI Bar	PSI Bar	Left rotation	Right rotation
WV-OP0.25	0.24	220	280	WVOP02	WVOP02
WV-OP0.45	0.45	220	280	WVOP04	WVOP04
WV-OP0.67	0.53	220	280	WVOP05	WVOP05
WV-OP0.76	0.75	220	280	WVOP08	WVOP08
WV-OP1.05	0.92	220	280	WVOP09	WVOP09
WV-OP1.27	1.25	220	280	WVOP09	WVOP09
WV-OP1.52	1.48	220	280	WVOP11	WVOP11
WV-OP2.30	2.28	190	230	WVOP13	WVOP13

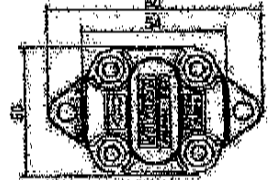

P1) Max. working pressure - P3) Max. backpressure  
 For heavy-duty applications, it is recommended to check the ultimate strength of the shaft

TYPE	Weight kg	A	B	C	D	D1
		mm	mm	mm	R	DUT
WV-OP0.25	0.510	58.5	24.5	47.4	1/4" BSPP	1/4" BSPP
WV-OP0.45	0.420	58.0	27.3	48.0	1/4" BSPP	1/4" BSPP
WV-OP0.67	0.430	59.0	27.3	50.0	1/4" BSPP	1/4" BSPP
WV-OP0.76	0.440	59.5	28.5	51.5	1/4" BSPP	1/4" BSPP
WV-OP0.95	0.450	59.5	28.5	53.0	1/4" BSPP	1/4" BSPP
WV-OP1.27	0.480	64.5	30.5	55.5	1/4" BSPP	1/4" BSPP
WV-OP1.52	0.500	65.5	31.5	57.5	1/4" BSPP	1/4" BSPP
WV-OP2.30	0.480	72.5	34.5	62.5	1/4" BSPP	1/4" BSPP

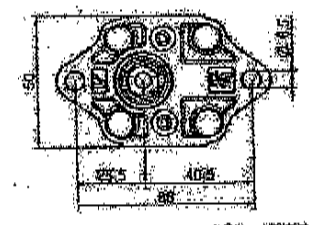
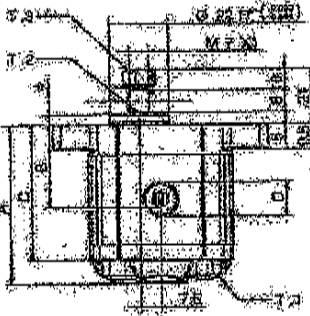

T1 = 11.7 - 13.7 [Nm] - screw tightening torque  
 T2 = 2.1 [Nm] - allowable shaft torque  
 T3 = 11.5 [Nm] - torque versus rating 11

unidirectional pump - series WV

WV-OP

STANDARD PUMP WV BODY INLET AND OUTLET  
#22 FLANGE - PARALLEL SHAFT



W O P 06 A B B A

Series	WV	series WV
Group	0	group 0
Category	P	unidirectional pump
Displacement	06	0.76
Rotation	A	022 right rotation
Shaft	A	0100 Parallel - M22 - key 1x2
Inlet	A	1x1/4" GAS
Outlet	A	1x1/4" GAS
Cover	A	standard



Reference WP001

Technical data table

TYPE	Displacement cm <sup>3</sup> /rev	Max. Pressure		Rotation	CODE
		P1 bar	P2 bar		
WV-OP0.47	0.46	220	260	W O P 04 A B B A	W O P 04 A B B A
WV-OP0.57	0.56	220	260	W O P 05 A B B A	W O P 05 A B B A
WV-OP0.76	0.75	220	260	W O P 06 A B B A	W O P 06 A B B A
WV-OP1.06	1.02	220	260	W O P 07 A B B A	W O P 07 A B B A
WV-OP1.27	1.25	220	260	W O P 08 A B B A	W O P 08 A B B A
WV-OP1.52	1.49	220	260	W O P 09 A B B A	W O P 09 A B B A
WV-OP2.30	2.25	190	240	W O P 15 A B B A	W O P 15 A B B A

P1 Max. working pressure - P2 Max. peak pressure  
For heavy duty applications, it is recommended to check the admissible torque of the shaft

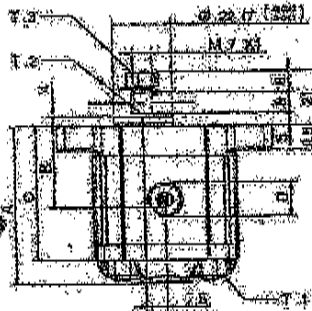
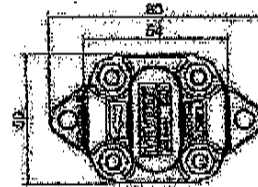

Dimensions table

TYPE	Weight kg	A	B	C	D	E
		mm	mm	mm	IN	OUT
WV-OP0.47	0.400	52.5	25.2	48.8	1/4" BSPP	1/4" BSPP
WV-OP0.57	0.430	59.0	27.8	50.0	1/4" BSPP	1/4" BSPP
WV-OP0.76	0.440	60.5	28.5	51.5	1/4" BSPP	1/4" BSPP
WV-OP1.06	0.480	62.0	29.5	53.0	1/4" BSPP	1/4" BSPP
WV-OP1.27	0.480	64.5	30.5	55.5	1/4" BSPP	1/4" BSPP
WV-OP1.52	0.500	65.5	31.5	57.5	1/4" BSPP	1/4" BSPP
WV-OP2.30	0.650	92.5	34.5	84.5	3/4" BSPP	3/4" BSPP

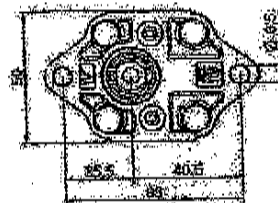

T1 = 11.7-18.7 [Nm] - screw tightening torque M6  
T2 = 2.1 [Nm] - approx. shaft torque  
T3 = 17.5 [Nm] - torque wrench setting 11

# unidirectional pump - series XV

**XV-IP**

STANDARD EUROPEAN PUMP  
#25.4 FLANGE - TAPER SHAFT



**X I P 25 02 F I I A**

Series	X	series XV
Group	1	group 1
Category	P	unidirectional pump
Displacement	25	cm <sup>3</sup>
Flange	02	#25.4 STANDARD EUROPEAN right rotation
Shaft	F	CODE: tapered shaft - ISO - key 10x2.4
Body	IN	ISO - D40 Ø12 M6
Outlet	OUT	ISO - Ø40 Ø12 M6
Socket	A	standard

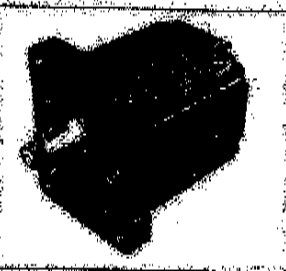

Reference: **XP101**

TYPE	Displacement cm <sup>3</sup>	Max. Pressure		CODE
		P1 bar	P2 bar	
XV-IP0.8	0.81	290	380	X I P 08 02 F I I A
XV-IP1.2	1.07	290	290	X I P 12 02 F I I A
XV-IP1.6	1.36	290	290	X I P 16 02 F I I A
XV-IP2.0	1.80	250	300	X I P 20 02 F I I A
XV-IP2.4	2.12	250	300	X I P 24 02 F I I A
XV-IP3.0	2.84	250	300	X I P 30 02 F I I A
XV-IP3.6	3.16	250	300	X I P 36 02 F I I A
XV-IP4.0	4.04	250	300	X I P 40 02 F I I A
XV-IP5.0	5.05	250	300	X I P 50 02 F I I A
XV-IP5.5	5.50	250	300	X I P 55 02 F I I A
XV-IP7.0	7.04	220	280	X I P 70 02 F I I A
XV-IP8.0	8.08	190	230	X I P 80 02 F I I A

P1: Max. working pressure - P2: Max. peak pressure  
For heavy-duty applications, it is recommended to check the suitability torque of the shaft

TYPE	Weight kg	Dimensions									
		A	B	C	D	E	F	G	H	I	J
XV-IP0.8	0.800	78.0	67.0	69.0	ø12	30	M6x1	ø12	30	M6x1	
XV-IP1.2	0.970	78.0	27.5	67.0	ø12	30	M6x1	ø12	30	M6x1	
XV-IP1.6	1.010	80.5	28.0	69.0	ø12	30	M6x1	ø12	30	M6x1	
XV-IP2.0	1.050	84.5	30.5	72.5	ø12	30	M6x1	ø12	30	M6x1	
XV-IP2.4	1.090	85.5	31.5	74.5	ø12	30	M6x1	ø12	30	M6x1	
XV-IP3.0	1.120	88.5	32.5	76.5	ø12	30	M6x1	ø12	30	M6x1	
XV-IP3.6	1.170	90.5	33.5	78.5	ø12	30	M6x1	ø12	30	M6x1	
XV-IP4.0	1.200	93.5	35.0	81.5	ø12	30	M6x1	ø12	30	M6x1	
XV-IP5.0	1.260	97.0	36.0	85.0	ø12	30	M6x1	ø12	30	M6x1	
XV-IP5.5	1.300	98.5	38.0	88.5	ø12	30	M6x1	ø12	30	M6x1	
XV-IP7.0	1.350	103.5	39.0	91.5	ø12	30	M6x1	ø12	30	M6x1	
XV-IP8.0	1.500	112.5	54.5	100.5	ø12	30	M6x1	ø12	30	M6x1	

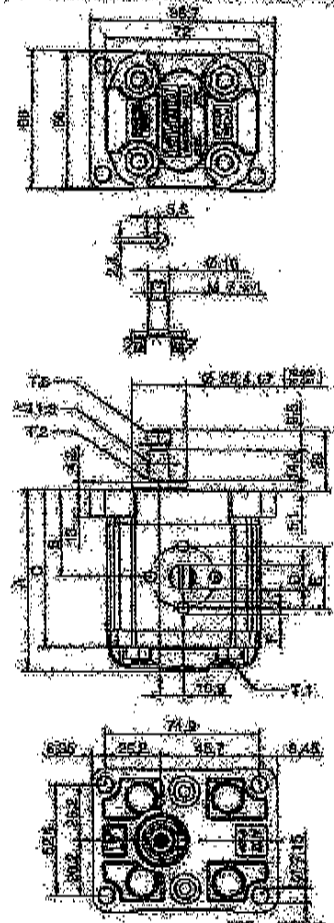

T1 = 24.5-29.4 [Nm] - screw tightening torque M5  
T2 = 42 [Nm] - adjustment shaft torque  
T3 = 1.5 [Nm] - torque wrench setting 11